

# 2436

**CARSON®** Spec Grade

## COVER

Style: T-Cover  
 Material: HDPE  
 Model: 24" x 36"  
 Weight: 37 lbs  
 Std. Fasteners: 3/8" Hex Bolt  
 Options: Logos and Special Markings  
 Surface: Skid Resistant & Marked  
 Performance: Pedestrian, ASTM C857, WUC 3.6

Cover comes standard with permanent markings for manufacturer and model size.

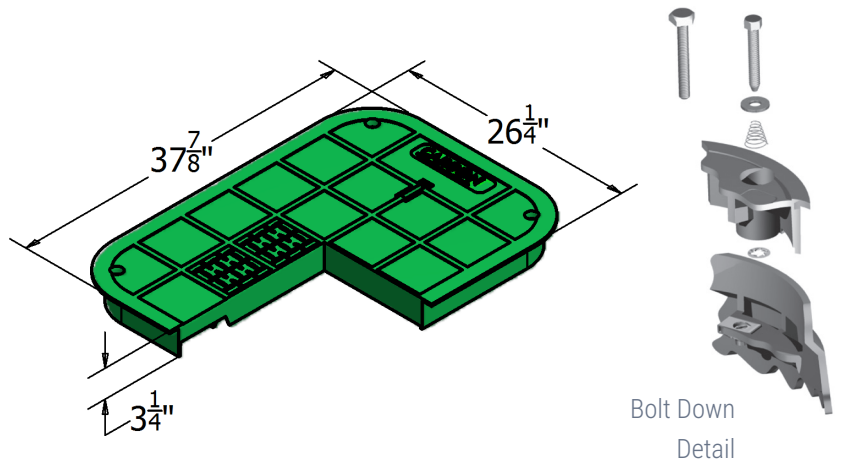

## BODY

Material: HDPE  
 Model: 24" x 36"  
 Weight: 18" Depth: 47 lbs  
           24" Depth: 62 lbs  
 Wall Type: Flared  
 Mouseholes: 0  
 Performance: Pedestrian, ASTM C857, WUC 3.6

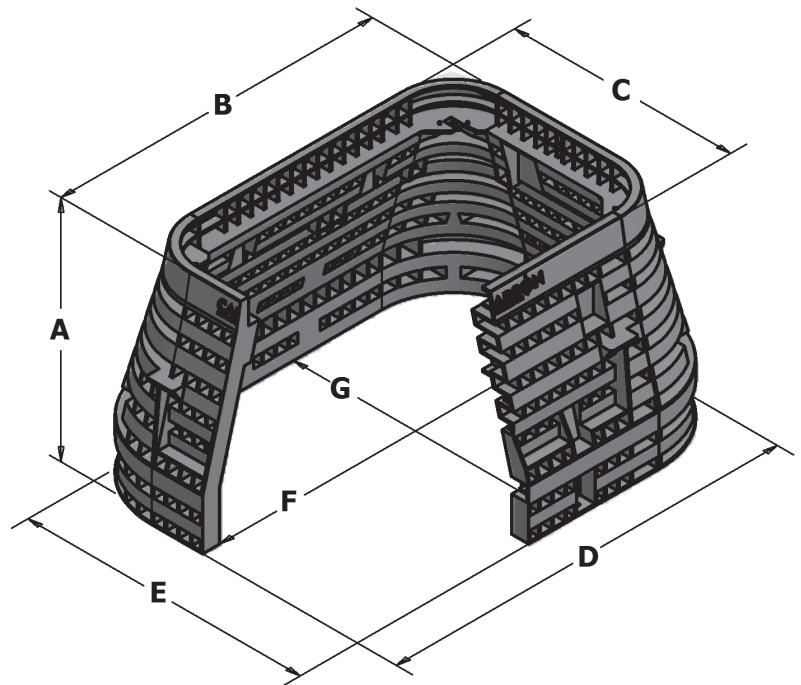

## LOAD RATING / NOTES



**LIGHT DUTY**  
 PEDESTRIAN / GREENBELT

For use in non-vehicular traffic situations only.  
 Weights and dimensions may vary slightly.  
 Actual load rating is determined by the box  
 and cover combination.

A	B	C	D	E	F	G
18"	37-3/4"	26-1/4"	47"	35-3/8"	42-7/8"	31-1/4"
24"	37-3/4"	26-1/4"	47"	35-3/8"	42-7/8"	31-1/4"

# 2436

**CARSON<sup>®</sup>** *Spec Grade*

## COVER OPTIONS

HDPE, T-Cover Solid

HDPE, Flush Solid

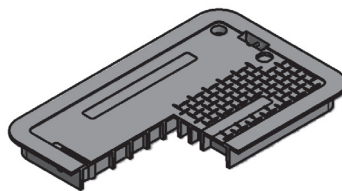

T-Cover Solid

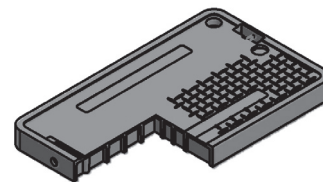

Flush Solid

## COLOR OPTIONS

Cover: Green, Gray

Body: Black, Gray

## FASTENER OPTIONS

Hex Head Bolt (A)

Penta Head Bolt (B)

Penta Head Coil Thread Bolt (B)

Oldcastle Vandal Resistant Bolt (C)

Captive Bolt Retainer

Drop-N-Lock<sup>™</sup>



Standard Thread



A



B



C



Coil Thread



Bolt Retainer  
(for standard thread)

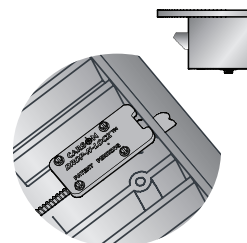

Drop-N-Lock  
(T-Cover only)

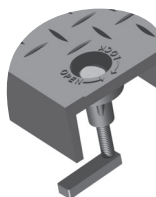

L Bolt Detail

 **WARNING:** Cancer - [www.P65Warnings.ca.gov](http://www.P65Warnings.ca.gov)

All information contained on this sheet is current at the time of publication.  
Oldcastle reserves the right to discontinue or update product information without notice.

Revision 11/30/18

© 2018 Oldcastle Infrastructure