

COVER

| | |
|--------------|----------------|
| Style: | Flush Solid |
| Material: | Composite |
| Model: | 17" x 30" |
| Weight: | 35 lbs. |
| Surface: | Slip Resistant |
| Performance: | 20K |

COVER OPTIONS

| | |
|---------|----------------------------|
| Custom: | Logos and Special Markings |
| Style: | (A) Flush Solid |
| | (B) Reader Door |
| | (C) AMR |
| | (D) AMR and Reader Door |

FASTENER OPTIONS

| | |
|--------|------------------|
| Style: | Hex Head |
| | Penta Head |
| | Vandal Resistant |
| | L Bolt |

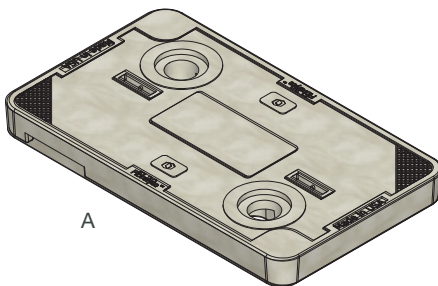

A

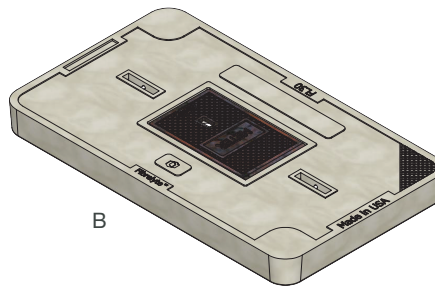

B

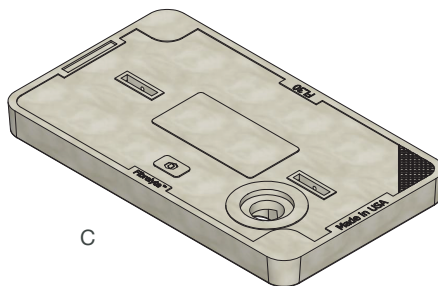

C

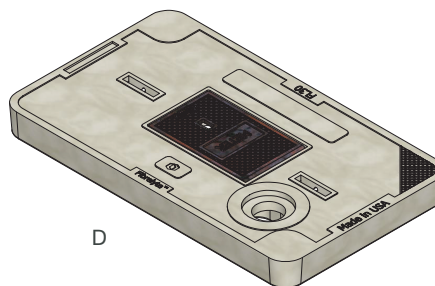

D



Hex Head



Penta Head



Vandal Resistant

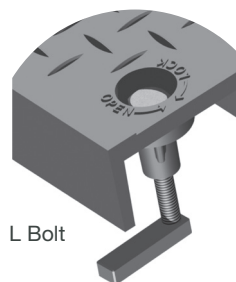

L Bolt



Medium Duty:
Incidental,
Non-deliberate Traffic

For use in non-vehicular traffic situations only.

Actual load rating is determined by the box and cover combination.

Weights and dimensions may vary slightly.