

COVER

Style:	Flush
Material:	Polymer Concrete
Model:	13" x 24"
Std. Fasteners:	1/2-13 Stainless Steel Hex Head Bolt, Washer and Floating Nut
Options:	Logos and Special Markings
Surface:	Slip Resistant
Performance:	ANSI/SCTE-77 Tier 15

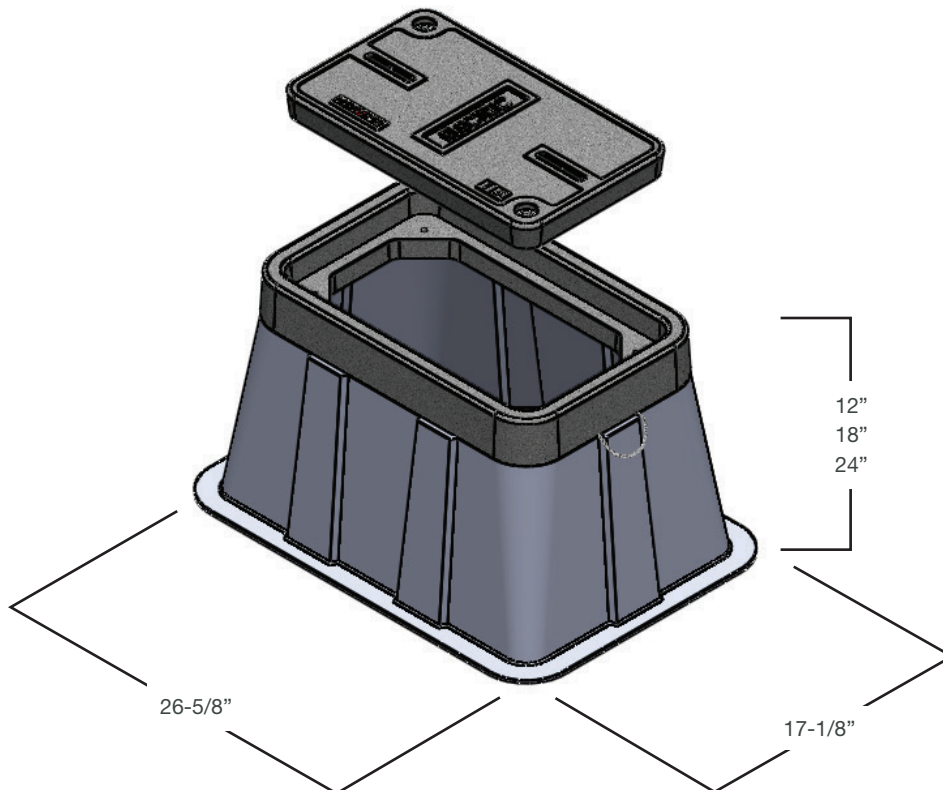

BODY

Material:	Fiber Reinforced Polymer w/ Polymer Concrete Ring
Model:	13" x 24"
Depths:	12", 18", 24"
Wall Type:	Flared
Performance:	ANSI/SCTE-77 Tier 15



Medium Duty:
Incidental,
Non-deliberate Traffic

For use in non-vehicular traffic situations only.

Actual load rating is determined by the box and cover combination.

Weights and dimensions may vary slightly.

OPTIONS

AVAILABLE POLYMER COVER:

Flush

FASTENER OPTIONS FOR POLYMER COVERS:

Penta Head Bolt

Oldcastle Enclosures Vandal Resistant Bolt

Penta Coil Thread Bolt

Captive Bolt Retainer

ADD ON OPTIONS:

EMS Marker (E)

Mouseholes/Knockouts

Rack Mount (A)

Cable Racks/Cable Arms (B)

Unistrut (C)

Pulling Eye - 1,000 lb and 3,000 lb (D)

Ground Buss (F)

Dividers

Racking Provision

Lid Gaskets*

*Lid Gaskets inhibit water flow into the box, they do not make enclosure fully waterproof.

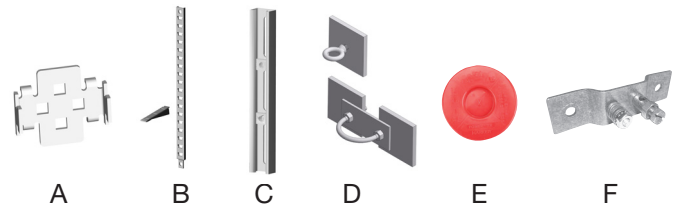
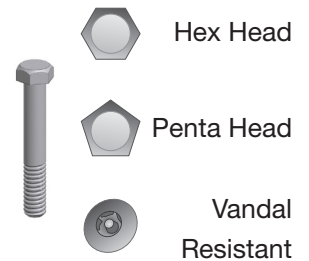
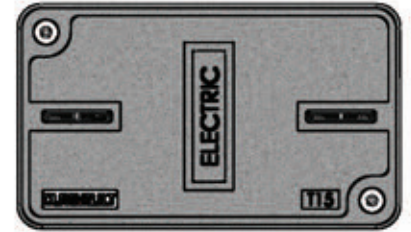

**PRODUCT
LOAD RATING**



Medium Duty: Incidental, Non-deliberate traffic

For use in non-vehicular traffic situations only. Actual load rating is determined by the box and cover combination.

NOTES

Actual load rating is determined by the box and cover combination.
Weights and dimensions may vary slightly