

# 48"- SLOPED INLET MANHOLE

SLOPED INLET GRATE	
Height	Weight
2"	240 lbs.

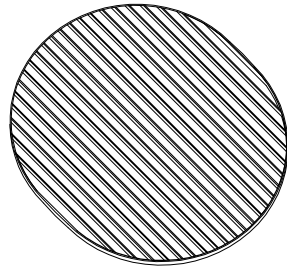

SLOPED OVAL INLET GRATE  
56"x 64" W/(23)  
1/2"x2" FLAT BARS 2 1/2" O.C.

## RISER SLOPED

Height	Weight
1'-6"	2,360 lbs.
2'-6"	3,230 lbs.

Lift Pin or Hole  
(2 Places Typ.)

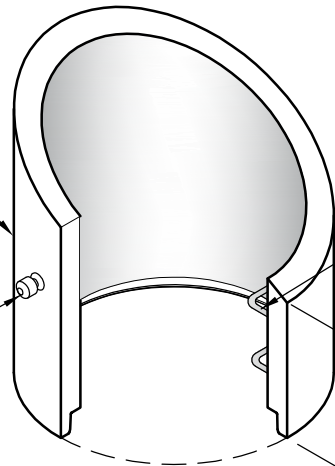

30' SLOPED INLET

Steps Mounted  
on Short Side

See Riser Chart

## BASE

Outside Height	Weight
2'-0"	2,800 lbs.
3'-0"	3,830 lbs.
4'-0"	4,740 lbs.
5'-0"	5,400 lbs.

Lift Pin or Hole  
(2 Places Typ.)

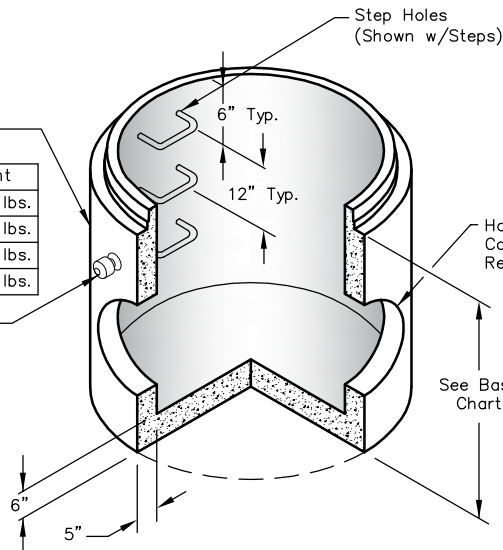

Step Holes  
(Shown w/Steps)

6" Typ.

12" Typ.

Holes or Flexible  
Connectors as  
Required

See Base  
Chart

6"

5"

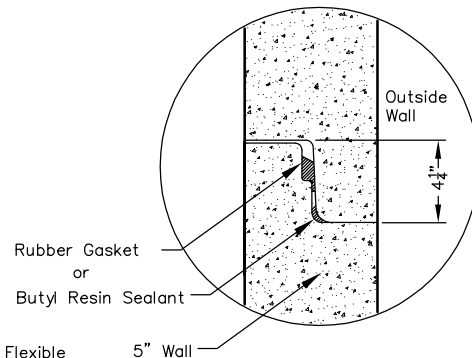

Rubber Gasket  
or  
Butyl Resin Sealant

5" Wall

## JOINT DETAIL

### Notes:

- Manholes per Specification: ASTM C478
- Rubber Gasket: ASTM C443
- Holes: Cored or Cast as Required.
- Steps: Copolymer Polypropylene Plastic w/#4 Bar in Center.
- Frame & Cover: Gray Cast Iron ASTM A48 Class 30, Watertight/Tamperproof Cover Available.
- Optional Extended Base Available.



PO Box 323, Wilsonville, Oregon 97070-0323  
Tel: (503) 682-2844 Fax: (503) 682-2657

## 48MH-SLOPED

File Name: 020EMM48-SLOPED-MH

Issue Date: 2016

[oldcastleprecast.com/wilsonville](http://oldcastleprecast.com/wilsonville)

## 48" SLOPED INLET MANHOLE