

60" MANHOLE

FRAME AND COVER

3" = 275 lbs.
7" = 350 lbs.

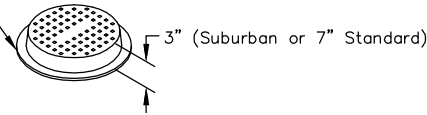

GRADE RING

2" = 80 lbs.
3" = 120 lbs.
4" = 165 lbs.
6" = 245 lbs.
12" = 490 lbs.

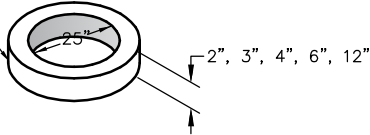

FLAT TOP

(Other Hole Sizes and Configurations Available)
3,050 lbs.

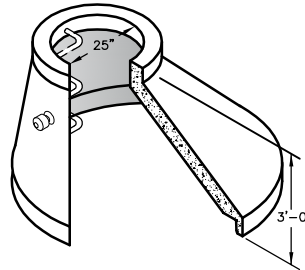
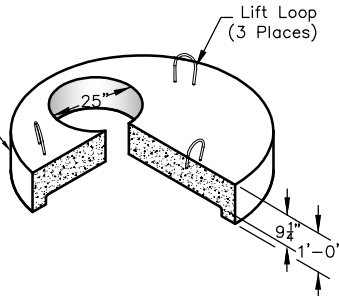

ECCENTRIC CONE

3,600 lbs.

RISER

Outside Height	Weight
1'-0"	1,270 lbs.
2'-0"	2,570 lbs.
3'-0"	3,870 lbs.
4'-0"	5,160 lbs.
5'-0"	6,460 lbs.
6'-0"	7,750 lbs.
7'-0"	9,050 lbs.
8'-0"	10,350 lbs.

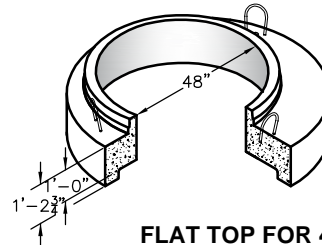
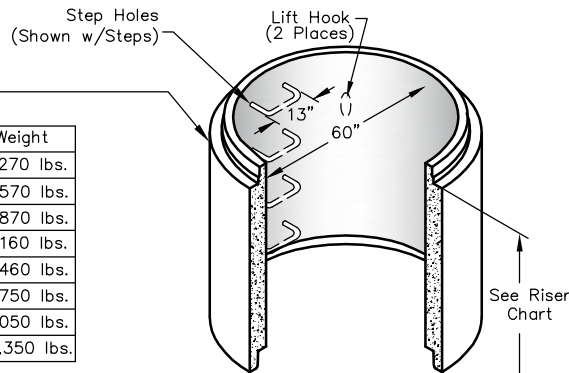

FLAT TOP FOR 48" MANHOLE

2,650 lbs.

BASE

Nominal Height	Weight*
2'-0"	5,520 lbs.
3'-0"	6,820 lbs.
4'-0"	8,110 lbs.
5'-0"	9,410 lbs.
6'-0"	10,710 lbs.
7'-0"	12,000 lbs.
8'-0"	13,300 lbs.

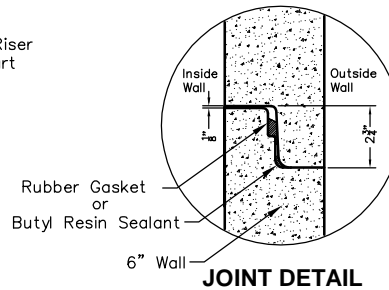
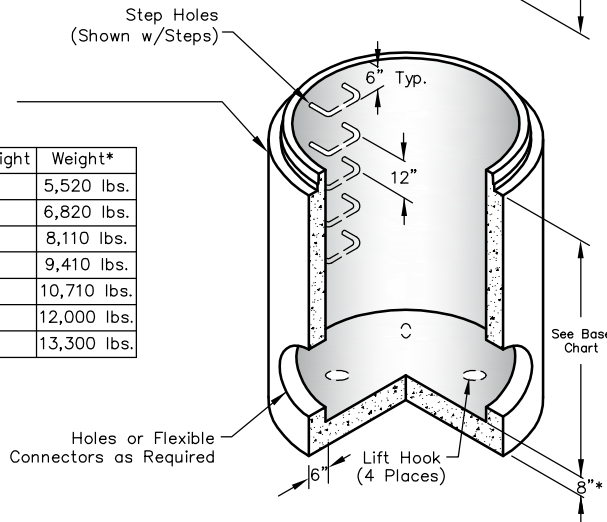

JOINT DETAIL

Notes:

- Manholes per Specification: ASTM C478
- Rubber Gasket: ASTM C443
- Holes: Cored or Cast as Required.
- Steps: Copolymer Polypropylene Plastic w/#4 Bar in Center.
- Frame & Cover: Gray Cast Iron ASTM A48 Class 30, Watertight/Tamperproof Cover Available.
- Optional Extended Base Available.

*Weights Shown for 8" Thick Floor. Optional 12" Floor Available.



PO Box 323, Wilsonville, Oregon 97070-0323
Tel: (503) 682-2844 Fax: (503) 682-2657

60" MANHOLE

File Name: 020-60MH

Issue Date: 2016

oldcastleprecast.com/wilsonville

60" MANHOLE