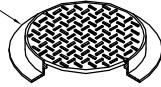
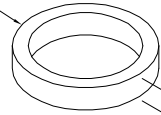
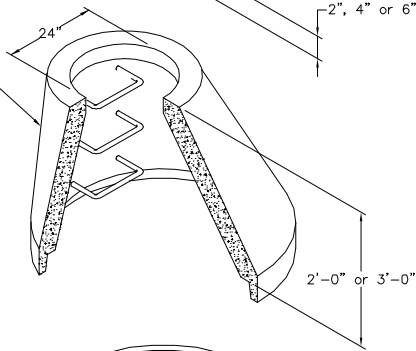

**FRAME AND COVER**

360 lbs

**GRADE RING**

 2" = 60 lbs  
 4" = 120 lbs  
 6" = 180 lbs

**ECCENTRIC CONE**

 2'-0" = 1,800 lbs  
 3'-0" = 2,700 lbs

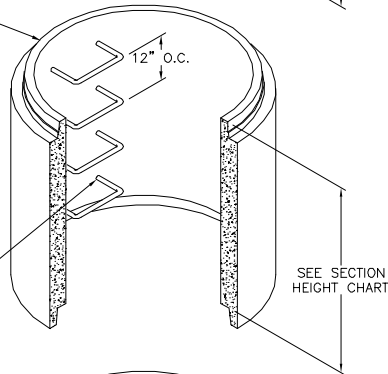
**SECTION**

HEIGHT	WEIGHT
1'-0"	870 lbs
2'-0"	1,740 lbs
3'-0"	2,610 lbs
4'-0"	3,480 lbs
5'-0"	4,350 lbs

 STEP HOLES  
 (SHOWN w/ STEPS)

**BASE**

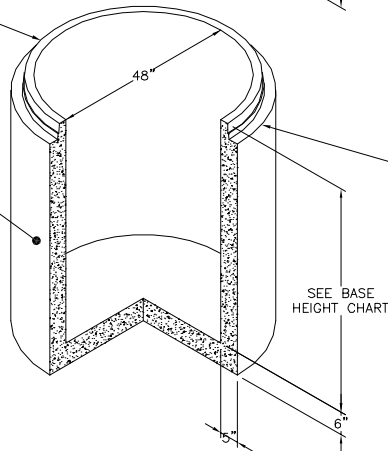
 PENETRATIONS PROVIDED  
 TO SUIT NEEDS

HEIGHT	WEIGHT
2'-0"	2,955 lbs
3'-0"	3,695 lbs
4'-0"	4,535 lbs
5'-0"	5,365 lbs

**UTILITY VAULT MANHOLES:**

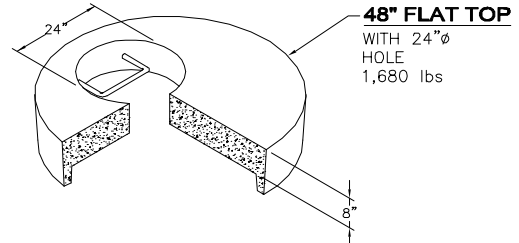
- H-20 LOADING
  - Manhole meets ASTM C478 and all WSDOT/APWA Standard Specifications
  - Rubber gasket joint meets ASTM C443
  - Polypropylene steps and ladders meet ASTM D4101
  - Reinforcement area meets minimum ASTM C478 requirements:
- Flat Top = 0.12 in.<sup>2</sup>/linear ft. in both directions, with 0.20 in.<sup>2</sup> at 90° around opening  
 2' tall Cones = 2 hoops of 0.250 in. dia. reinforcing bars  
 3' tall Cone = 3 hoops of 0.250 in. dia. reinforcing bars  
 Sections = 0.12 in.<sup>2</sup>/vertical ft.  
 Bases = 0.12 in.<sup>2</sup>/linear ft. in both directions (slab), 0.12 in.<sup>2</sup>/vertical ft. (wall)
- Knockout sizes and locations available to meet job requirements
  - Maximum hole size 36"
  - Minimum distance between holes 8"

**CONCENTRIC CONE**

1,800 lbs

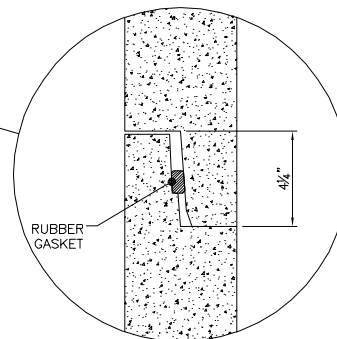
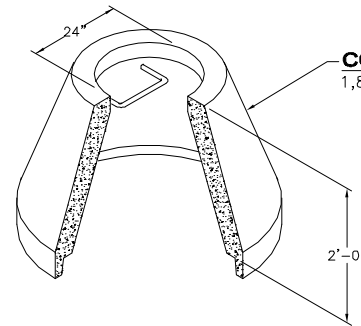
**JOINT DETAIL**
**AVAILABLE OPTIONS:**

- Pre-channeling
- Coatings
- Kor-n-seal boots
- Saddle bases