

**PLAN VIEW**  
SCALE: 1/4" = 1'-0"

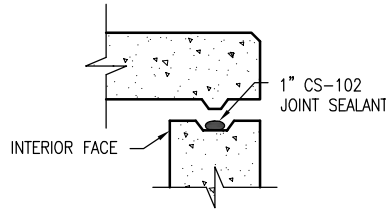

**TOP SLAB WITH TONGUE & GROOVE JOINT**  
**N.T.S.**

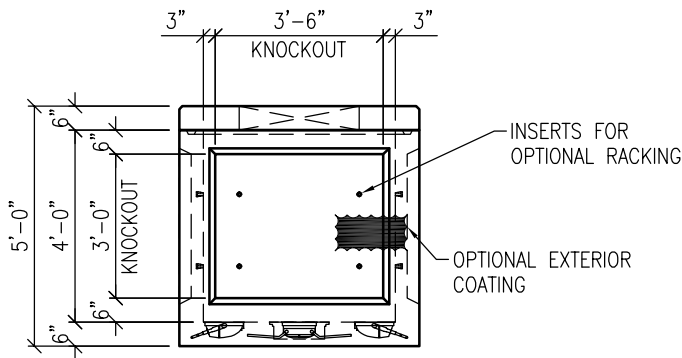

**VIEW A**  
SCALE: 1/4" = 1'-0"

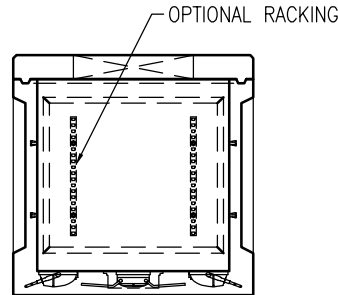

**SECTION Z**  
SCALE: 1/4" = 1'-0"

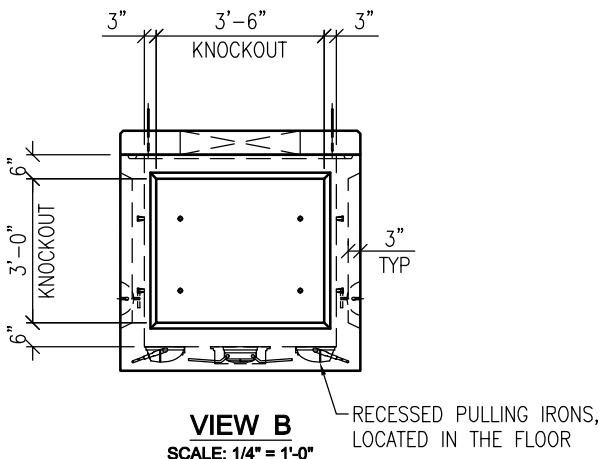

**VIEW B**  
SCALE: 1/4" = 1'-0"

**GENERAL NOTES:**

1. CONCRETE FC = 5,000 PSI.
2. REINFORCING STEEL, ASTM A-615
  - 2.1. FY = 60 KSI
3. DESIGN LIVE LOAD = HS-20
4. EARTH COVER = 0'-10" MIN. TO 3'-0" MAX.
5. BUTYL RUBBER JOINT SEALANT
6. CONTRACTOR TO:
  - 6.1. KNOCKOUT WINDOWS USED FOR DUCT BANKS SHALL BE FILLED WITH A MINIMUM OF 3000 PSI CONCRETE TIGHT TO THE UNDERSIDE OF THE UPPER SECTION FOR FULL THICKNESS OF WALL.

**WEIGHTS:**

- 4' x 4' TOP SLAB w/ 30" ACCESS: 0.77 TONS / 1539 LBS.
- 4' x 4' TOP SLAB w/ 36" ACCESS: 0.69 TONS / 1377 LBS.
- 4' x 4' x 4' BASE: 2.74 TONS / 5488 LBS.

SHIP-LOOSE ITEMS		
QTY	DESCRIPTION	ITEM ID
2 ROLLS	JOINT SEALANT 1" x 14.5' CS-102	5439200
OLDCASTLE ID		
QTY	DESCRIPTION	ITEM ID
1 EA.	4 x 4 TOP SLAB w/ 30" OPG.	0041400
1 EA.	4 x 4 TOP SLAB w/ 36" OPG.	0041450
1 EA.	4 x 4 x 4 BASE	0040400

**Oldcastle Precast**<sup>®</sup>  
**CHESAPEAKE**  
1401 TRIMBLE ROAD  
EDGEWOOD, MD 21040 410-812-1213  
5115 MASSAPONAX CHURCH ROAD  
FREDERICKSBURG, VA 22407 540-898-6300

OPI-CHESAPEAKE-INFO@OLDCASTLE.COM

**UV-444-KO**

FILE NAME: 365UV444KO.DWG

ISSUE DATE: June, 2017

SCALE: 1/4" = 1'-0"

Utility Vault  
4'-0" x 4'-0" x 4'-0" I.D.  
Knockout

Copyright © 2017 Oldcastle Precast, Inc.

