

**Heavy Duty Grate :**

Weight : 380 Lbs.

Open Area 651 Sq. Inches

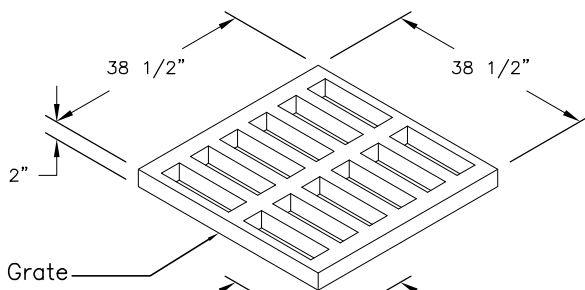

Cast Iron Grate

**6" Riser W/ Frame**

Weight : 510 Lbs.

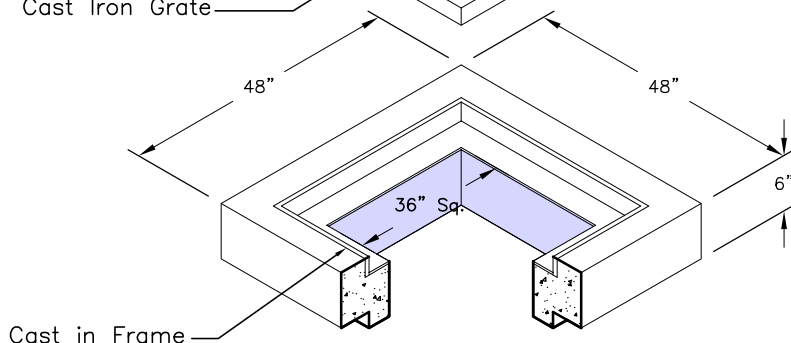

Cast in Frame

**Risers**

Weight : See Chart

Extension	
B	Weight (Lbs.)
6"	475
12"	1000

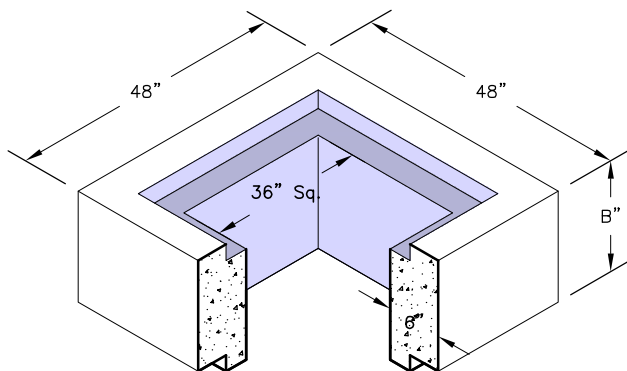
**Bottom :**

Weight : See Chart

Bottom	
Wall(s)	Weight (Lbs.)
4-Way	2,550

1" Chamfer (TYP. 4  
Corners, Top & Bottom)

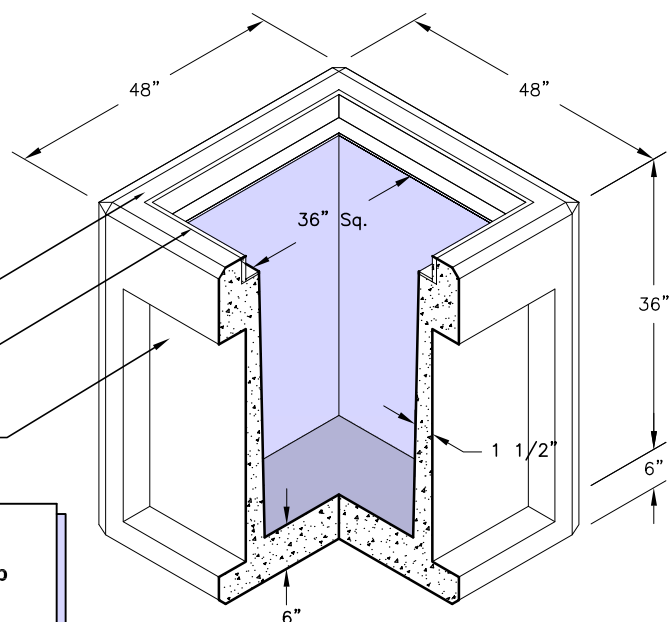
Cast in Frame (Optional)  
36" Wide x 36" Tall x 4"  
Deep Thin-wall Knockouts  
Typical on all Four Walls  
For 24" RCP or Smaller.

**GENERAL NOTES:**

- Bedding Shall be in Accordance With Job and Plan Specifications.