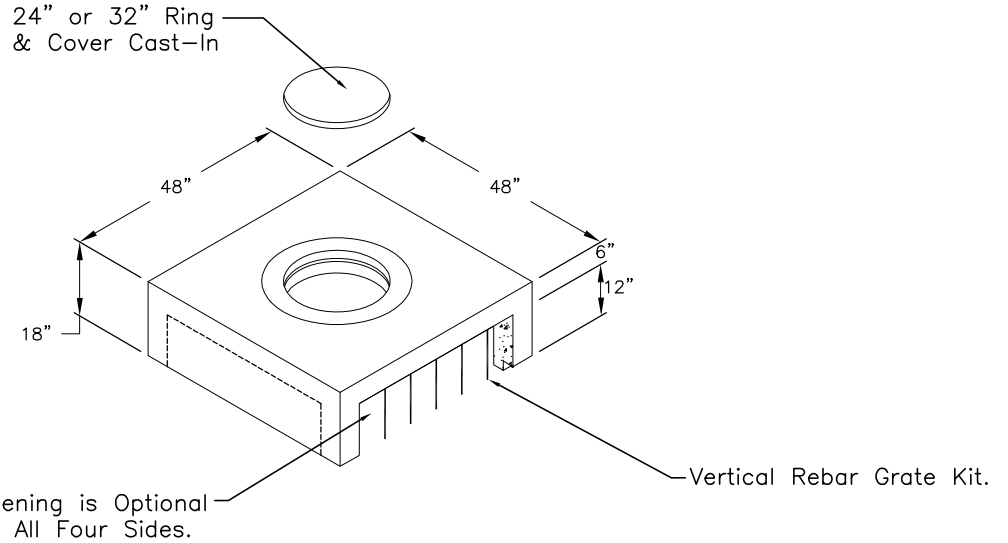
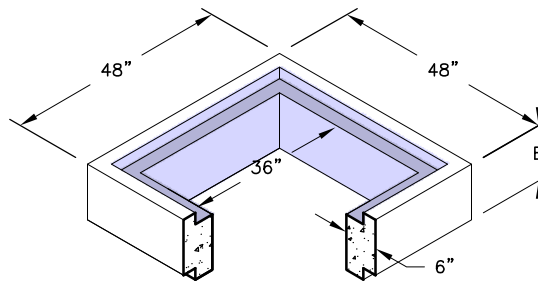

Type "E" Top

 Weight : Depends on Configuration
 Max Weight 1,820 lbs.

Variable Riser

Weight : See chart.

Riser	
B	Weight (Lbs.)
6"	495
12"	1,000
24"	2,000
36"	3,000
48"	4,000

Bottom :

Weight : See Chart

Bottom	
Wall(s)	Weight (Lbs.)
4-Way	3,014

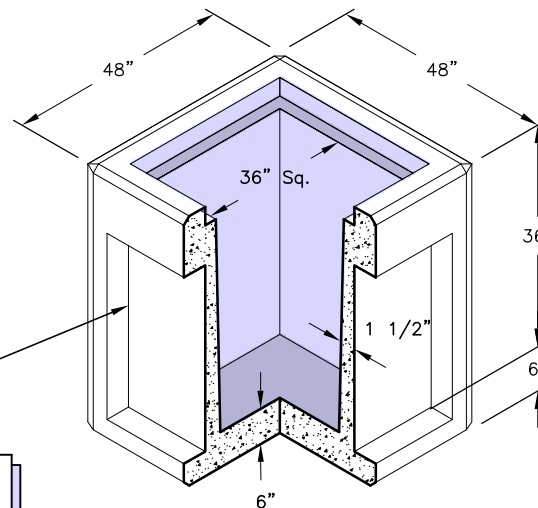
 Thinwall Knockout For
 24" R.C.P. or Smaller
 (Typical All Four Walls)

GENERAL NOTES:

1. Bedding Shall be in Accordance With Job and Plan Specifications.