

**AT&T ALP 148 Pad**

Weight: 1,440 Lbs.  
Item #: 1500500

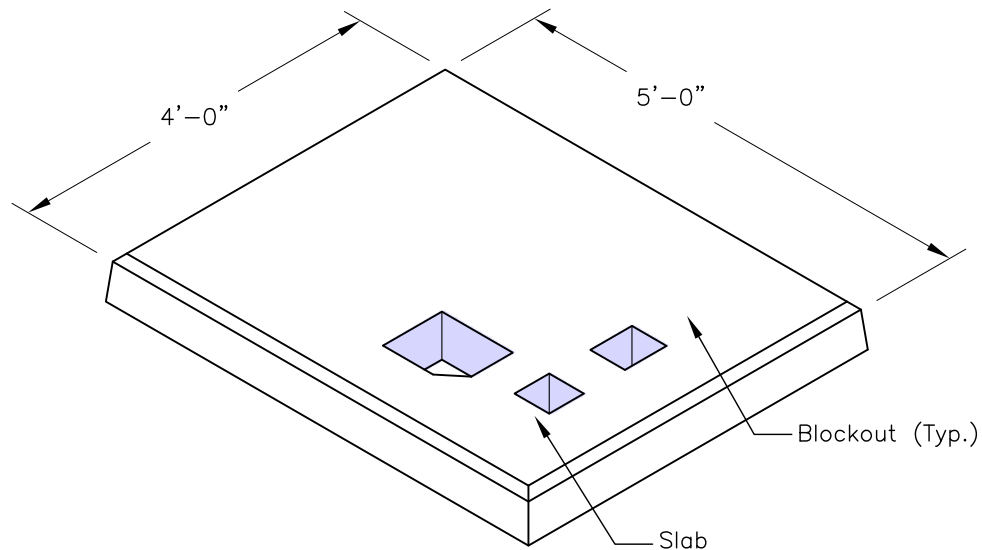

**SPECIFICATIONS:**

1. Concrete: Has a Design Strength of 5,000psi at 28 Days.
2. Steel Reinforcement: ASTM A-615, Grade 60.
3. Slab shall be supported by 3" Min. Layer of Level compacted crushed stone or sand bed.
4. Slab designed for 3,000 lb dead load.