

RING & COVER

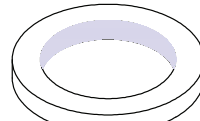

GRADE RING

Grade Ring Options					
Height	Access	Weight	Height	Access	Weight
0'-2"	ø24"	80 lbs.	0'-2"	ø37"	142 lbs.
0'-3"	ø24"	120 lbs.	0'-4"	ø37"	284 lbs.
0'-4"	ø24"	160 lbs.	0'-6"	ø37"	426 lbs.
0'-6"	ø24"	240 lbs.	1'-0"	ø37"	852 lbs.
0'-2"	ø30"	118 lbs.			
0'-3"	ø30"	177 lbs.			
0'-4"	ø30"	236 lbs.			
0'-6"	ø30"	354 lbs.			

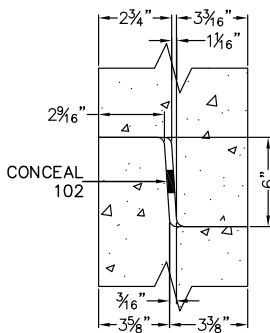

JOINT DETAIL

ALL RADII = 1/4"
N.T.S.

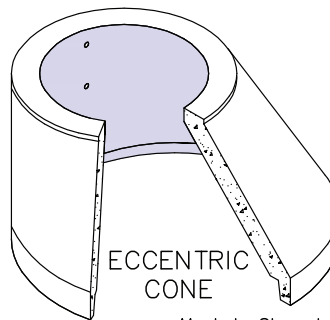

ECCENTRIC
CONE

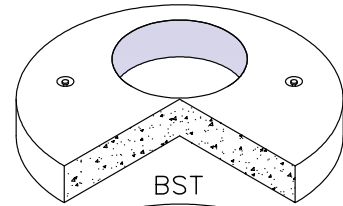

BST

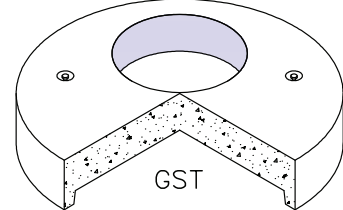

GST

Eccentric Cone Options			
Height	Access	Weight	Lift Gear
2'-8"	ø30"	4,800 lbs.	4 Ton Swift Lift
3'-0"	ø24"	6,000 lbs.	4 Ton Swift Lift

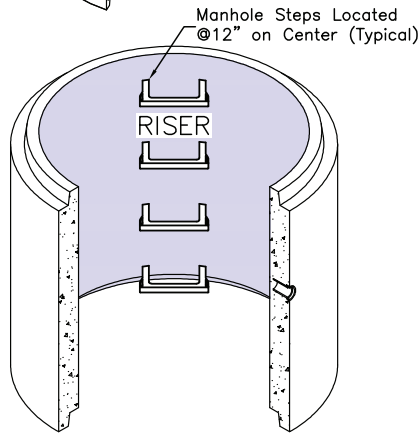

RISER

Riser Options		
Height	Weight	Lift Gear
1'-0"	1,810 lbs.	4 Ton Swift Lift
2'-0"	3,620 lbs.	4 Ton Swift Lift
3'-0"	5,430 lbs.	4 Ton Swift Lift
4'-0"	7,240 lbs.	4 Ton Swift Lift
5'-0"	9,050 lbs.	4 Ton Swift Lift
6'-0"	10,860 lbs.	4 Ton Swift Lift

Butt Slab Top Options (BST)			
*Access Hole Size And Location May Vary			
Height	Access	Weight	Lift Gear
8"	ø24"	3,720 lbs.	4 Ton Swift Lift
8"	ø30"	3,544 lbs.	4 Ton Swift Lift
8"	ø36"	3,328 lbs.	4 Ton Swift Lift

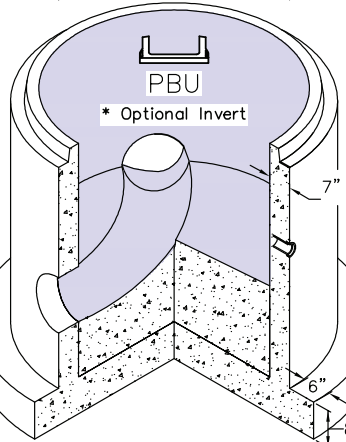

PBU

* Optional Invert

Base Options (PBU)		
**Weights Shown Do Not Include Invert		
Height	Weight	Lift Gear
3'-0"	11,160 lbs.	4 Ton Swift Lift
4'-0"	12,970 lbs.	4 Ton Swift Lift
5'-0"	14,780 lbs.	4 Ton Swift Lift
6'-0"	16,590 lbs.	4 Ton Swift Lift

Groove Slab Top Options (GST)			
*Access Hole Size And Location May Vary			
Height	Access	Weight	Lift Gear
1'-2"	ø24"	4,085 lbs.	4 Ton Swift Lift
1'-2"	ø30"	3,908 lbs.	4 Ton Swift Lift
1'-2"	ø36"	3,692 lbs.	4 Ton Swift Lift

Notes
1. ALL MANHOLE MATERIAL IS DESIGNED AND MANUFACTURED ACCORDING TO ASTM C-478 SPECIFICATIONS.
2. ALL MANHOLE MATERIAL IS SUITABLE FOR HS-20 LOADING.