

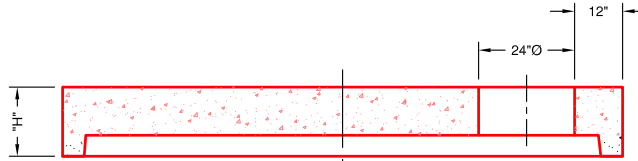

10' TOP SLAB

"H"	Wt.
18"	16,645#



10' DIA. BARREL

"H"	Wt.
24"	8,508#
36"	12,762#
48"	17,016#
60"	21,270#
72"	25,524#
84"	29,778#
96"	34,032#

*CAN PRODUCE HEIGHTS IN-BETWEEN

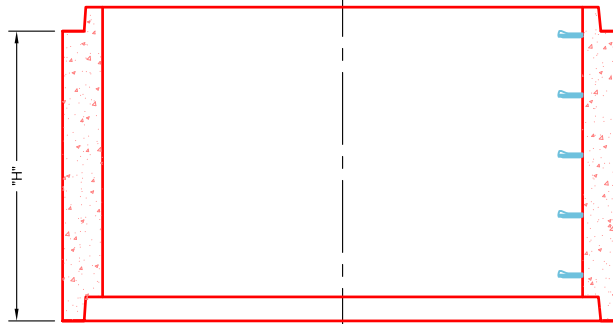

**10' DIA.
OCTAGON
BASE SLAB**

Wt.
23,530#

or

**10' DIA.
ROUND
BASE SLAB**

Wt.
24,740#

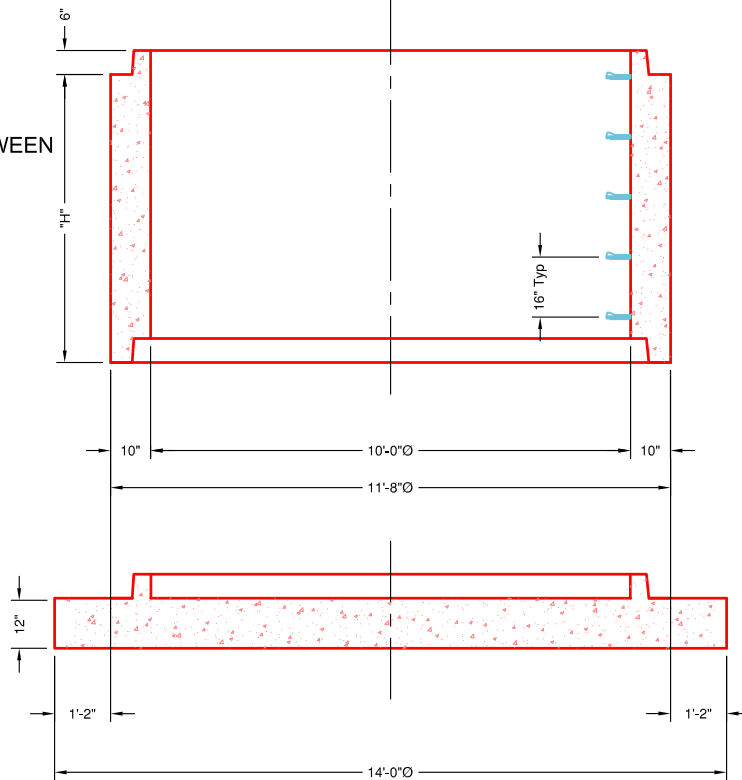

SECTIONAL VIEW

SPECIFICATIONS:

- Concrete minimum compression strength:
F'c=5,000 PSI @ 28 days.
- Reinforcing steel: ASTM A615, Fy=60,000 PSI

ITEMS ARE SUBJECT TO CHANGE WITHOUT NOTICE.