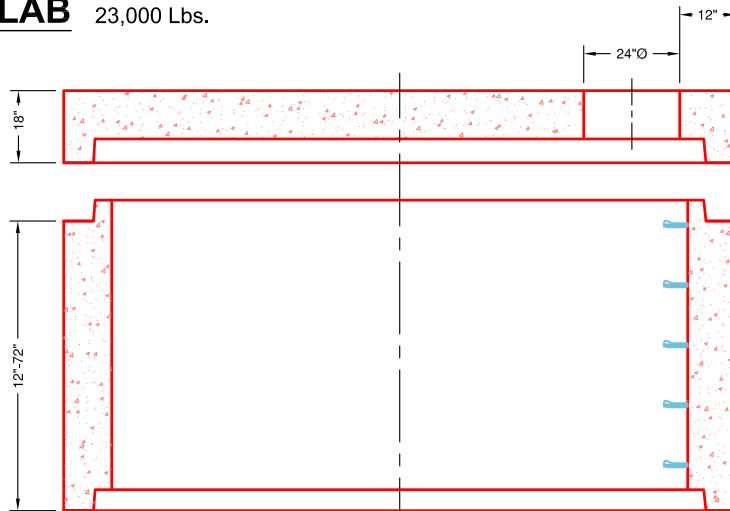
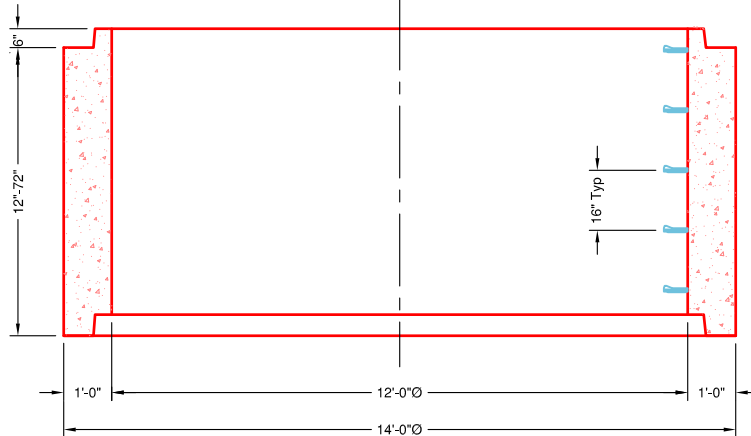
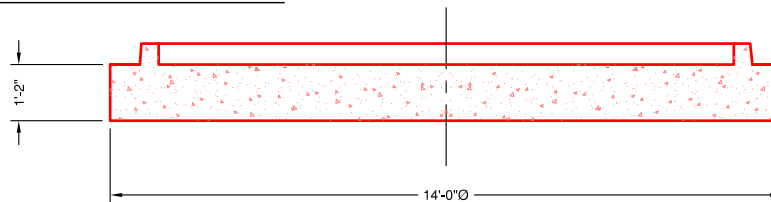

12' TOP SLAB 23,000 Lbs.

12' DIA. BARREL 6,125 Lbs/Ft

12' DIA. BASE SLAB 27,950#

SECTIONAL VIEW
SPECIFICATIONS:

1. Concrete minimum compression strength:
F'c=5,000 PSI @ 28 days.
2. Reinforcing steel: ASTM A615, Fy=60,000 PSI

ITEMS ARE SUBJECT TO CHANGE WITHOUT NOTICE.