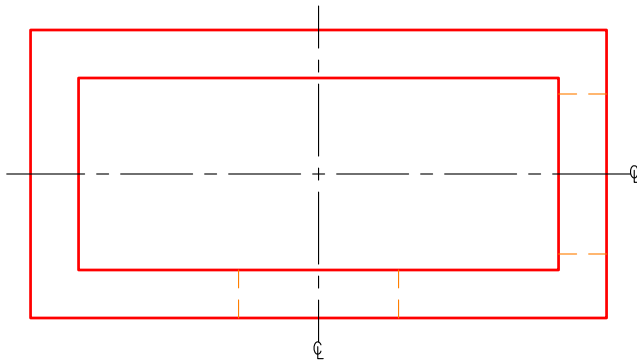
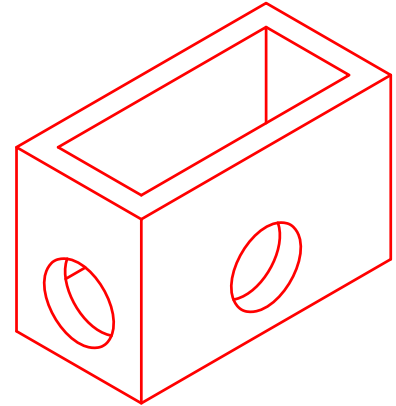
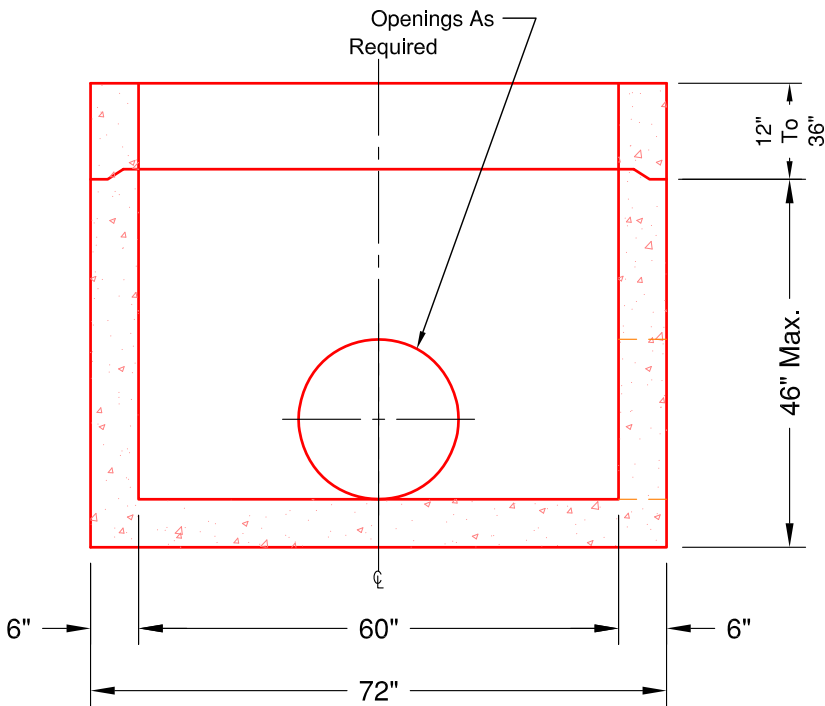
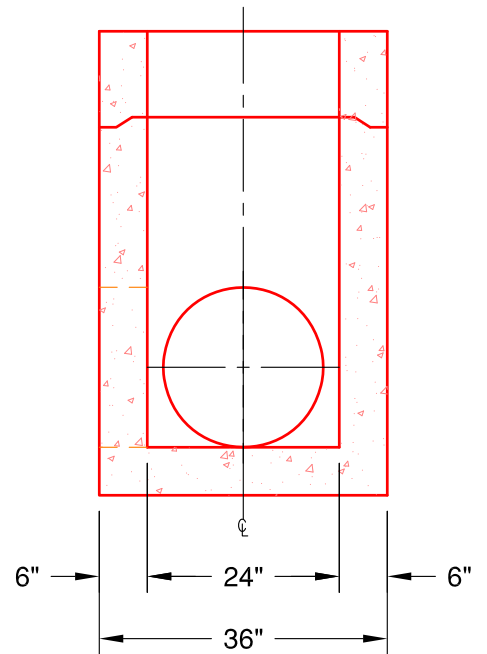

WEIGHTS	
SECTION	WEIGHT
BASE SECTION	5,400 LBS

PLAN VIEW

ISO VIEW
 SCALE: 1/8" = 1'-0"

SECTION

SECTION
SPECIFICATIONS:

1. Concrete minimum compression strength:
F'c=5,000 PSI @ 28 days.
2. Reinforcing steel: ASTM A615, Fy=60,000 PSI

ITEMS ARE SUBJECT TO CHANGE WITHOUT NOTICE.