

**PLAN VIEW**  
SCALE: 3/8" = 1'-0"

#5 REBAR EXTENDED 22"  
@ 12" O.C. (FIELD BEND  
AS REQUIRED)

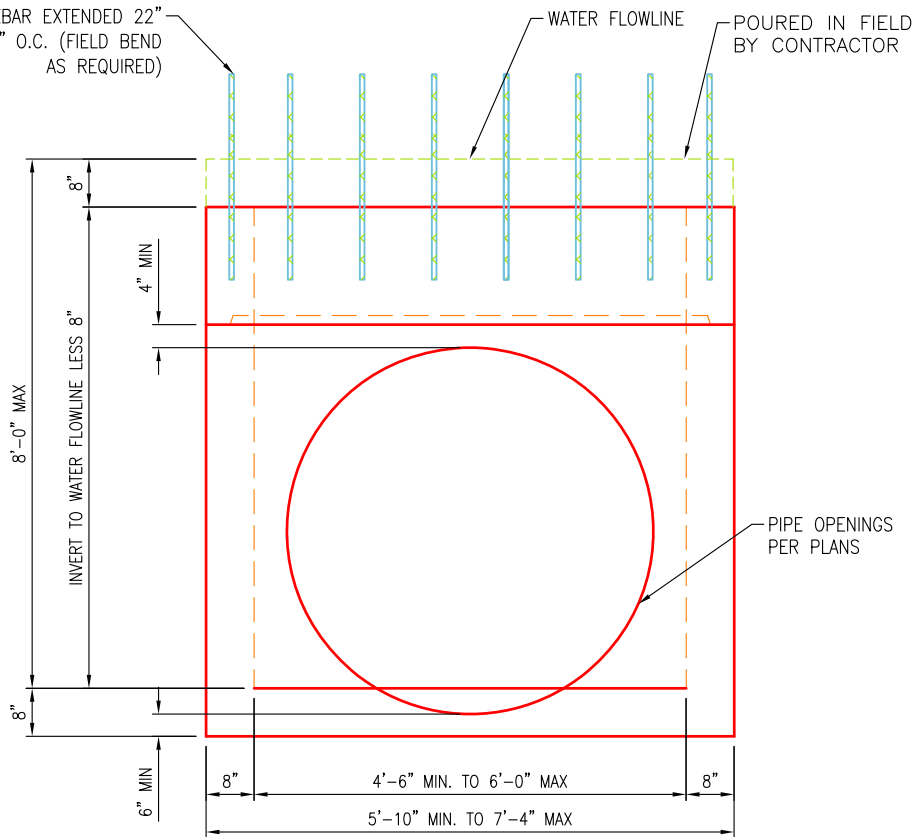

**SIDE VIEW**  
SCALE: 3/8" = 1'-0"

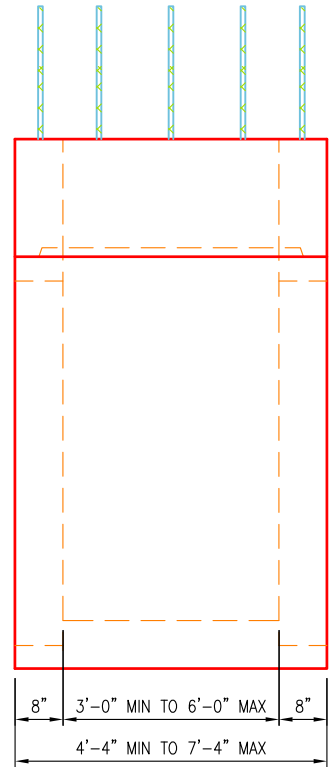

**END VIEW**  
SCALE: 3/8" = 1'-0"

**SPECIFICATIONS:**

1. Concrete minimum compression strength:  
F'c=5,000 PSI @ 28 days.
2. Reinforcing steel: ASTM A615, Fy=60,000 PSI

ITEMS ARE SUBJECT TO CHANGE WITHOUT NOTICE.