

**1'-0" of Riser**

Weight: 2,260 lbs.

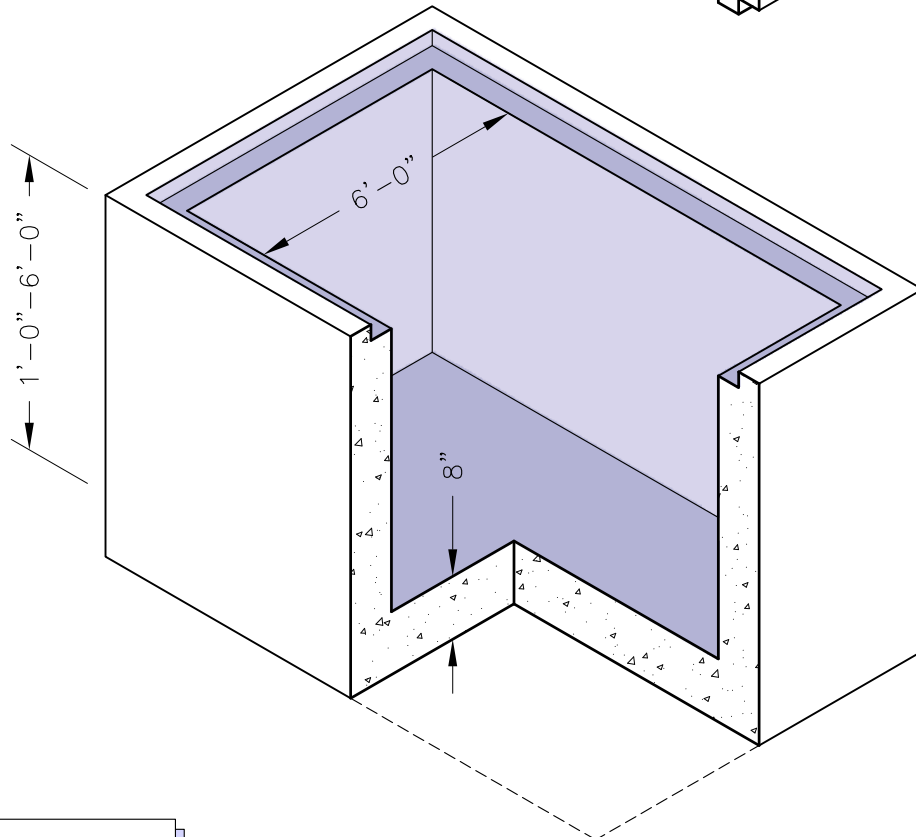

**Base Slab**

Weight: 6,300 lbs.

**SPECIFICATIONS:**

1. Concrete shall be 4000 PSI at 28 day compressive strength.
2. Structure conforms to ASTM C913-02.
3. Design: HS-25 traffic loading.

**GENERAL NOTES:**

1. Sections to be made in 6" increments.