

**SIDE VIEW**

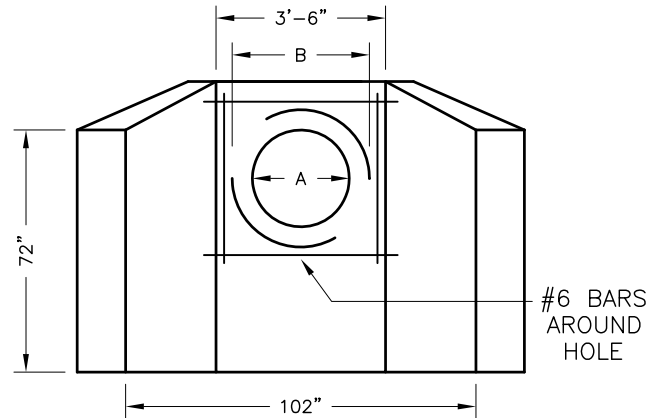

**FRONT VIEW**

	A	B	C
24" RCP	24"	34"	38"
27" RCP	27"	36"	36"
30" RCP	30"	42"	30"
36" RCP	36"	48"	24"
Weight ≈ 13,950 lbs.			

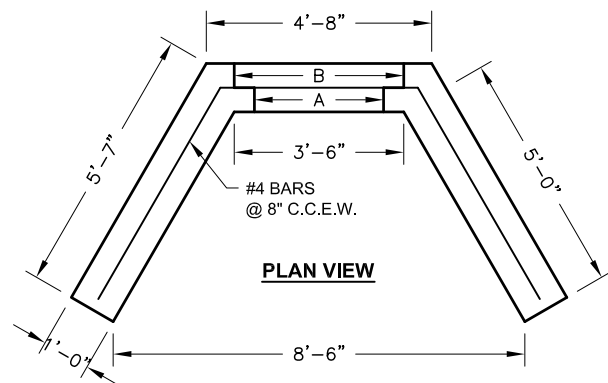

**PLAN VIEW**

**SPECIFICATIONS:**

1. Concrete: Has a design strength of 4,000 psi at 28 days.
2. Construction as per latest revision of ASTM C-890
3. Reinforcement bars as per ASTM A-615, Grade 60  
Horizontal Spacing = #4 Bars @ 12" C.C.  
Vertical Spacing = #4 Bars @ 12" C.C.

**GENERAL NOTES:**

1. Any alteration to this drawing must be submitted to Oldcastle Precast, Inc. prior to production.
2. Hole for pipe to be two stage hole.