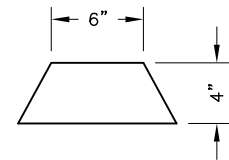
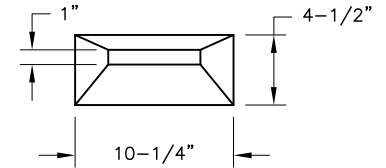
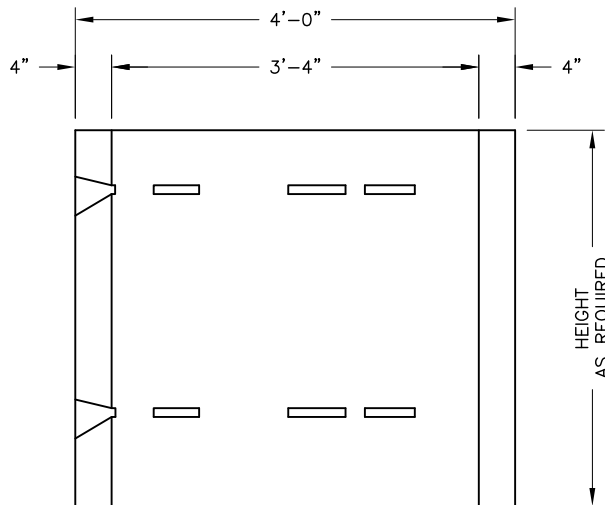

**PLAN**

**LEACHING BLOCK DETAIL**

**SECTION A-A**

SPECIFICATIONS			
RING HEIGHTS	VOLUME C.F.	VOLUME GAL.	APPROX. WEIGHT/LBS.
2'-0"	17.5	131	1150
3'-0"	26	196.5	1725
4'-0"	35	262	2300

**GENERAL NOTES:**

1. Concrete: 28 Day Compressive Strength  $f'_c = 4,000\text{psi}$ .
2. Steel Reinforcement: ASTM A-615, Grade 60, ASTM A-185.