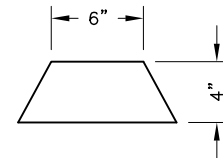
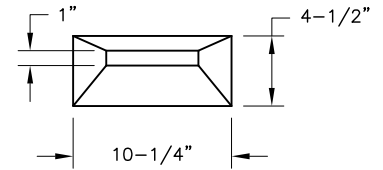
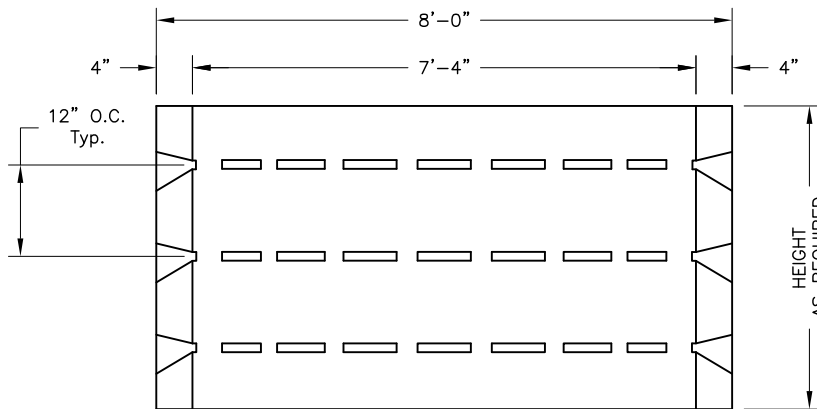

PLAN

LEACHING BLOCK DETAIL

SECTION A-A

| SPECIFICATIONS | | | | |
|----------------|---------------|-------------|-------------|---------------------|
| RING HEIGHTS | LEACHING AREA | VOLUME C.F. | VOLUME GAL. | APPROX. WEIGHT/LBS. |
| 3'-0" | 75 S.F. | 126 | 940 | 3450 |
| 3'-6" | 87 S.F. | 147 | 1100.7 | 4025 |
| 4'-0" | 100 S.F. | 168 | 1258 | 4600 |
| 4'-6" | 113 S.F. | 189 | 1415.2 | 5175 |
| 5'-0" | 125 S.F. | 210 | 1561 | 5750 |

GENERAL NOTES:

1. Concrete: 28 Day Compressive Strength $f'_c = 4,000\text{psi}$.
2. Steel Reinforcement: ASTM A-615, Grade 60, ASTM A-185.