

**96" Dia. Transition Slab**

 Weight: 6,450 lbs.  
 Item #: 1106360

**96" Dia. Grooved Slab Top**

Access	Item #	Weight
24" Concentric	1106305	6,975 Lbs.
24" Eccentric	1106300	6,975 Lbs.
30" Concentric	1106315	6,800 Lbs.
30" Eccentric	1106310	6,800 Lbs.

**96" Dia. Flat Slab Top**

Access	Item #	Weight
24" Concentric	1106330	6,775 Lbs.
24" Eccentric	1106320	6,775 Lbs.
30" Concentric	1106340	6,600 Lbs.
30" Eccentric	1106350	6,600 Lbs.

**96" Dia. Risers**

Height	Item #	Weight
1'-0"	1106020	3,100 Lbs.
2'-0"	1106050	6,200 Lbs.
3'-0"	1106080	9,300 Lbs.
4'-0"	1106110	12,400 Lbs.
5'-0"	1106120	15,500 Lbs.
6'-0"	1106130	18,600 Lbs.

**96" Dia. Base**

Height	Item #	Weight
2'-0"	1106200	19,200 Lbs.
3'-0"	1106210	22,300 Lbs.
4'-0"	1106220	25,400 Lbs.
5'-0"	1106230	28,500 Lbs.
6'-0"	1106240	31,600 Lbs.

**GENERAL NOTES:**

1. Manhole Walls, Transition Slabs, Cones, Tops and Base Sections Meet or Exceed ASTM C-478.
2. Joint Connections to be Gaskets Conforming to ASTM C-443 Requirements.
3. Resilient Connectors to be Boots Conforming to ASTM C-923 Requirements.
4. Following Coatings available upon request: (Thane-Coat, Bitumastic, Tnemec)

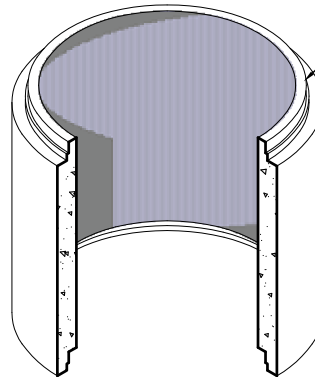
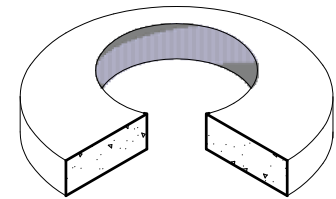
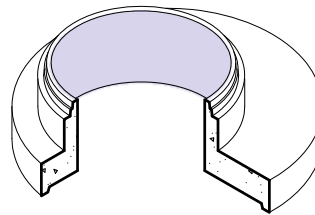
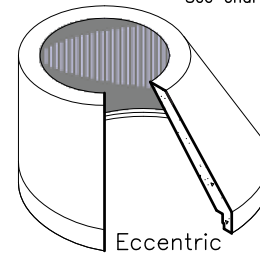
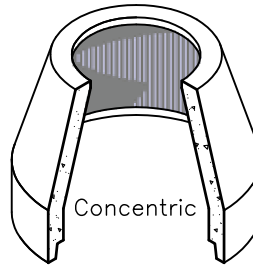
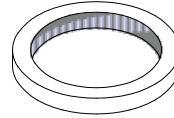
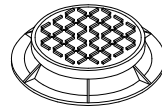

See Joint Options on Chart

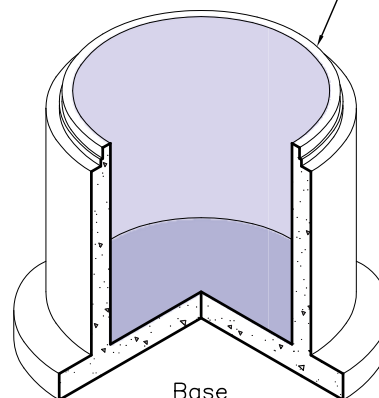
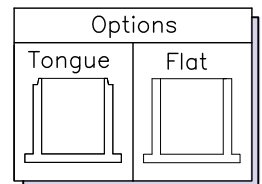
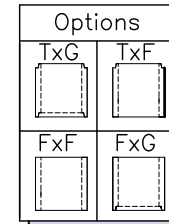

Base

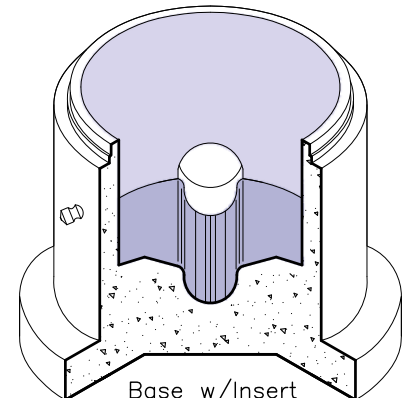

Base w/Insert

See Joint Options on Chart

**Ring & Cover :**

\*Note: Varies Per Customer Specs

**35" x 3" Grade Ring**

Weight : 145 Lbs.

**24" x 3" Grade Ring**

Weight : 105 Lbs.

**48" Dia. Eccentric Cone**

See chart for model 48-MH.

**48" Dia. Concentric Cone**

See chart for model 48-MH.