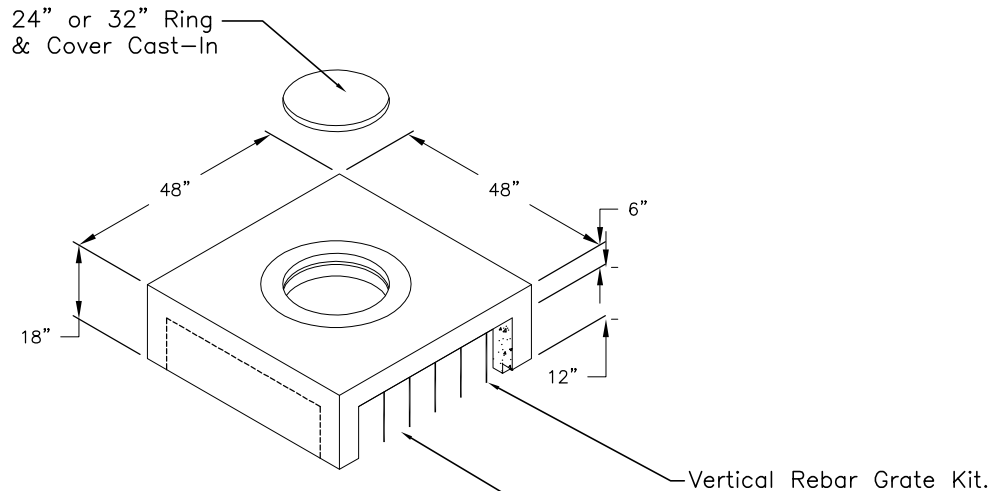

**Type "E" Top**

Weight : Depends on Configuration  
 Max Weight 1,820 lbs.

**Variable Riser**

Weight : See chart.

Riser	
B	Weight (Lbs.)
6"	495
12"	1,000
24"	2,000
36"	3,000
48"	4,000

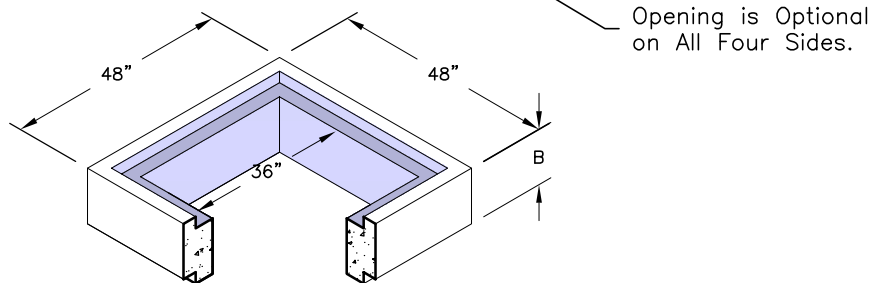
**Bottom :**

Weight : See Chart

Bottom	
Wall(s)	Weight (Lbs.)
4-Way	3,014

Thinwall Knockout For  
 24" R.C.P. or Smaller  
 (Typical All Four Walls)

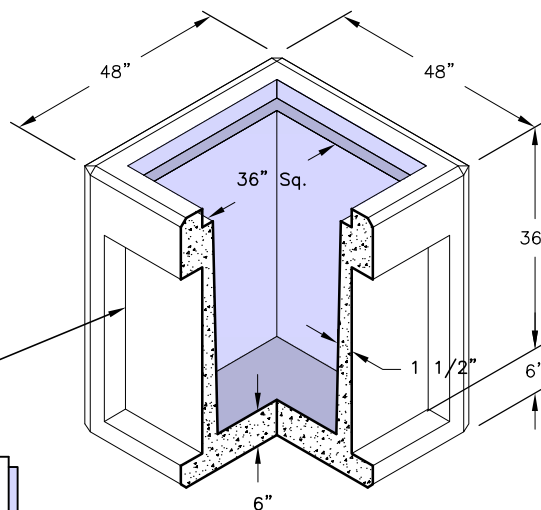
**GENERAL NOTES:**

1. Bedding Shall be in Accordance With Job and Plan Specifications.