

Ring & Cover  
 per Specs

**Top :**

Weight : 5,380 Lbs.

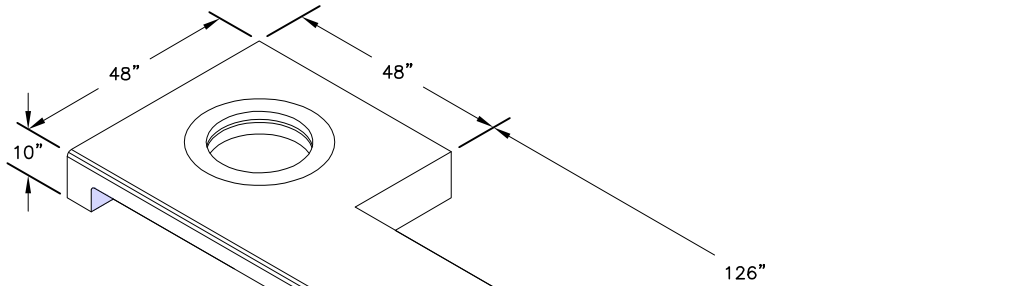

**18" Mid-Section**

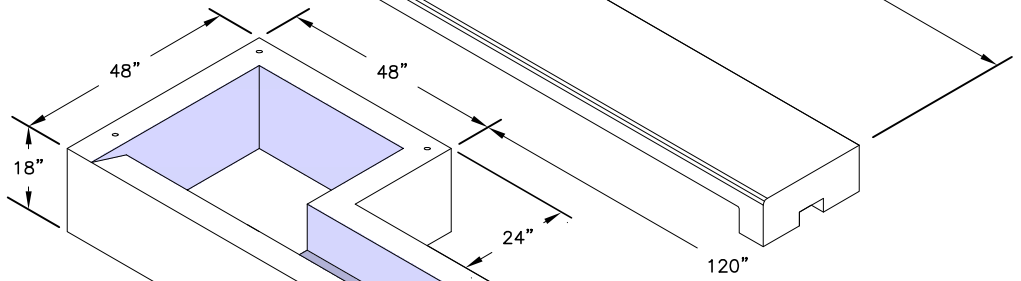
Weight : 6,197 Lbs.

**Variable Riser**

Weight : See chart.

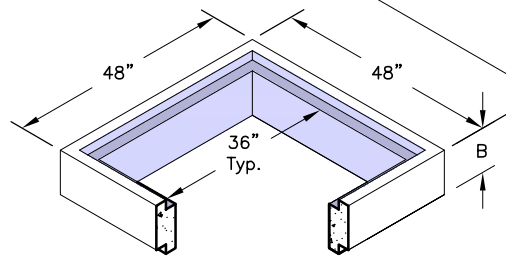
Riser	
B	Weight (Lbs.)
6"	495
12"	1,000

**Bottom :**

Weight : See Chart

Bottom	
Wall(s)	Weight (Lbs.)
4-Way	3,220

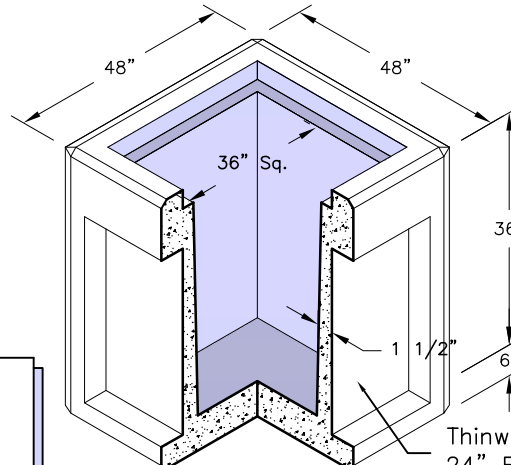
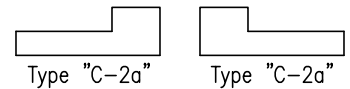
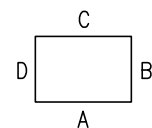
**Extension Options**

**Typical Orientation**

 Thinwall Knockout For  
 24" R.C.P. or Smaller  
 (Typical All Four Walls)

**GENERAL NOTES:**

1. Bedding Shall be in Accordance With Job and Plan Specifications.