

Ring & Cover :

*Note: Varies Per Plan details and Specs

35" x 3" Grade Ring

Weight : 145 Lbs.

24" x 3" Grade Ring

Weight : 105 Lbs.

48" Dia. Conc Cone

Weight : Varies

Cone	
Access	Weight (Lbs.)
24"	1,550
35"	1,530

72" Dia. Flat Slab

Weight : Varies

Flat Slab	
Access	Weight (Lbs.)
24"	3,360
35"	3,335

72" Dia. Risers

Weight : See Chart

Riser	
B	Weight (Lbs.)
12"	1,761
24"	3,518
36"	5,280
48"	7,041

72" Dia. Bases

Weight : See Chart

** Weights do not include invert

Ext. Base	
A	Weight (Lbs.)
12"	**6,939
18"	**7,818
24"	**8,700
30"	**9,579
36"	**10,458
42"	**11,340
48"	**12,219
54"	**12,490
60"	**12,490

GENERAL NOTES:

1. Manhole Walls, Transition Slabs, Cones, Tops, and Base Sections Meet or Exceed the Requirements of ASTM C-478.
2. Joint Connections to be Gaskets Conforming to ASTM C-443 Requirements.
3. Resilient Connectors to be Boots Conforming to ASTM C-923 Requirements
4. Following Coatings available upon request: (Thane-Coat, Bitumastic, Tnemec)

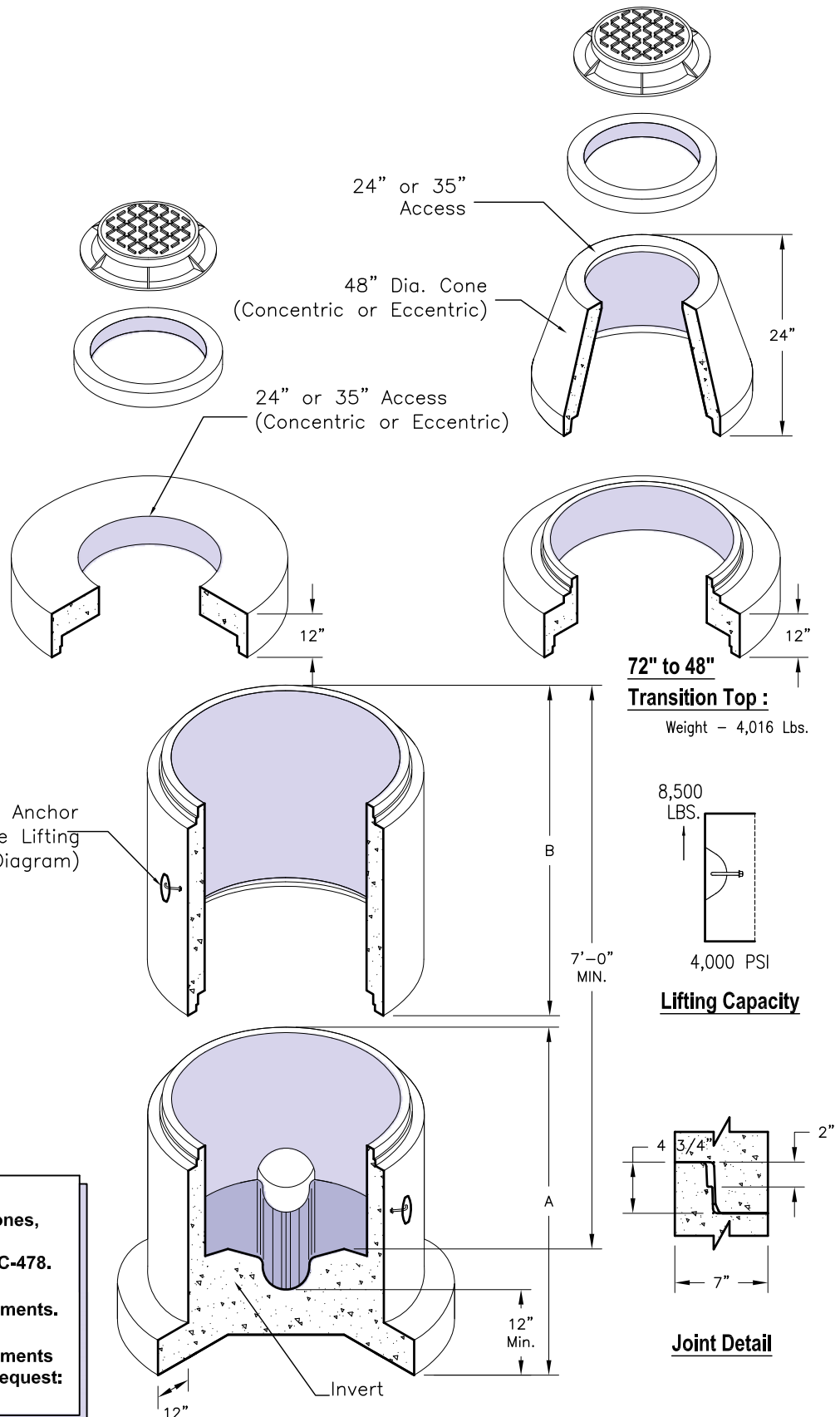
72" to 48" Transition Top :

Weight - 4,016 Lbs.

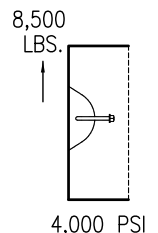
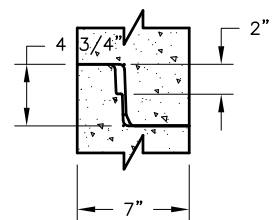
Lifting Capacity

Joint Detail