

**PLAN VIEW**

Precast Wing Wall  
Options Available.

**GENERAL NOTES:**

1. Concrete: 28 Day Compressive Strength  $f'c = 5,000$  psi
2. Steel Reinforcement: ASTM A-615, Grade 60
3. Design Live Load: HS-20
4. Earth Cover: 0'-6" Min to 5'-0" Max

Structure	H (Rise)	Waterway Areas	Section Weights
OM 12/4	4 ft	14 sf	10.4 Tons
OM 12/6	6 ft	38 sf	12 Tons
OM 12/8	8 ft	62 sf	13.6 Tons
OM 12/10	10 ft	86 sf	15.2 Tons
OM 12/12	12 ft	110 sf	16.8 Tons

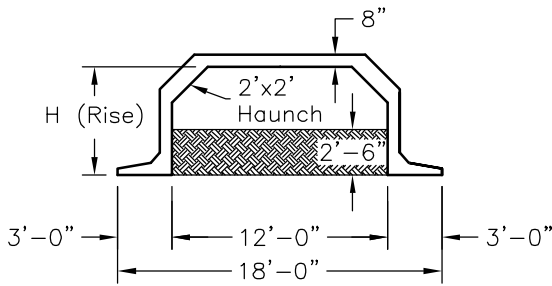

**ELEVATION VIEW**

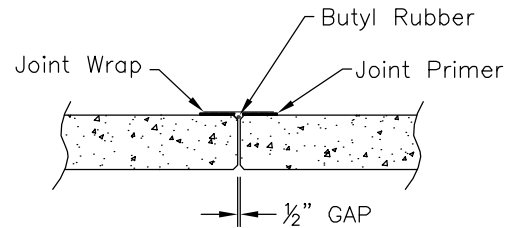
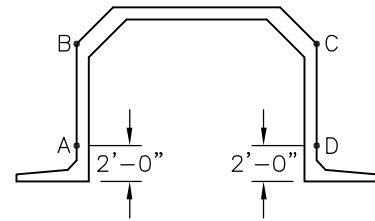

**DETAIL FROM B-C**

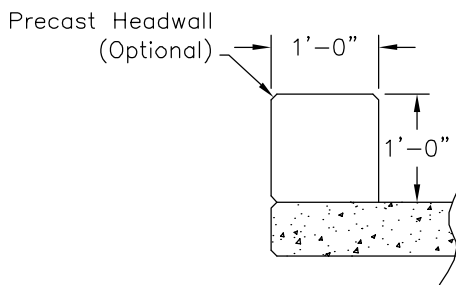

**HEADWALL OPTION**

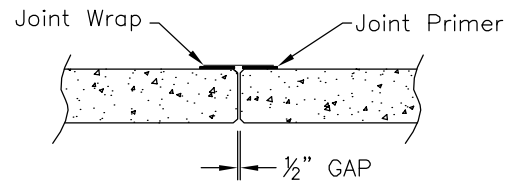

**DETAIL FROM A-B & C-D**

SCALE: 3/32" = 1'-0"



5115 Massaponax Church Road, Fredericksburg, Virginia  
Phone: 540.898.6300 Fax: 540.898.2389

**OM 12 SERIES**

FILE NAME: OMEGA BRIDGE - 12

ISSUE DATE: January, 2003

**12'-0" Span  
Omega Bridge  
Standard Layout**

Copyright © 2003 Oldcastle Precast, Inc.