

PLAN VIEW

Precast Wing Wall Options Available.

GENERAL NOTES:

1. Concrete: 28 Day Compressive Strength $f'_c = 5,000$ psi
2. Steel Reinforcement: ASTM A-615, Grade 60
3. Design Live Load: HS-20
4. Earth Cover: 0'-6" Min to 5'-0" Max

| Structure | H (Rise) | Waterway Areas | Section Weights |
|-----------|----------|----------------|-----------------|
| OM 8/4 | 4 ft | 8 sf | 8.8 Tons |
| OM 8/6 | 6 ft | 24 sf | 10.4 Tons |
| OM 8/8 | 8 ft | 40 sf | 12 Tons |
| OM 8/10 | 10 ft | 56 sf | 13.6 Tons |
| OM 8/12 | 12 ft | 72 sf | 15.2 Tons |

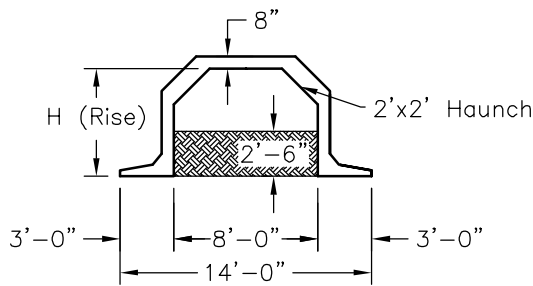

ELEVATION VIEW

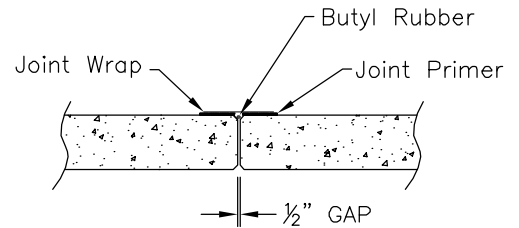
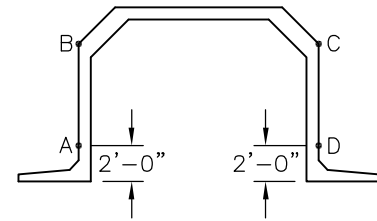

DETAIL FROM B-C

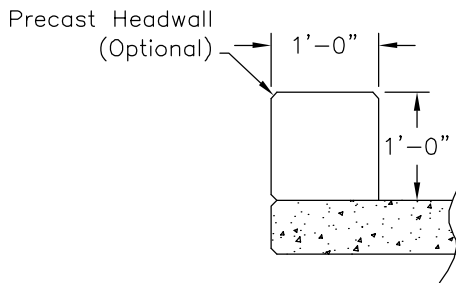

HEADWALL OPTION

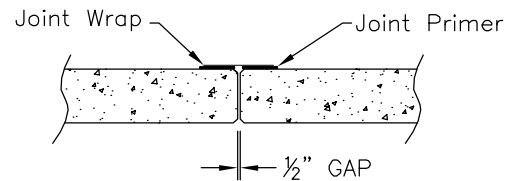

DETAIL FROM A-B & C-D

SCALE: 3/32" = 1'-0"



5115 Massaponax Church Road, Fredericksburg, Virginia
Phone: 540.898.6300 Fax: 540.898.2389

OM 8 SERIES

FILE NAME: OMEGA BRIDGE - 8

ISSUE DATE: January, 2003

**8'-0" Span
Omega Bridge
Standard Layout**

Copyright © 2003 Oldcastle Precast, Inc.