

MODUcover

Assembly Guide

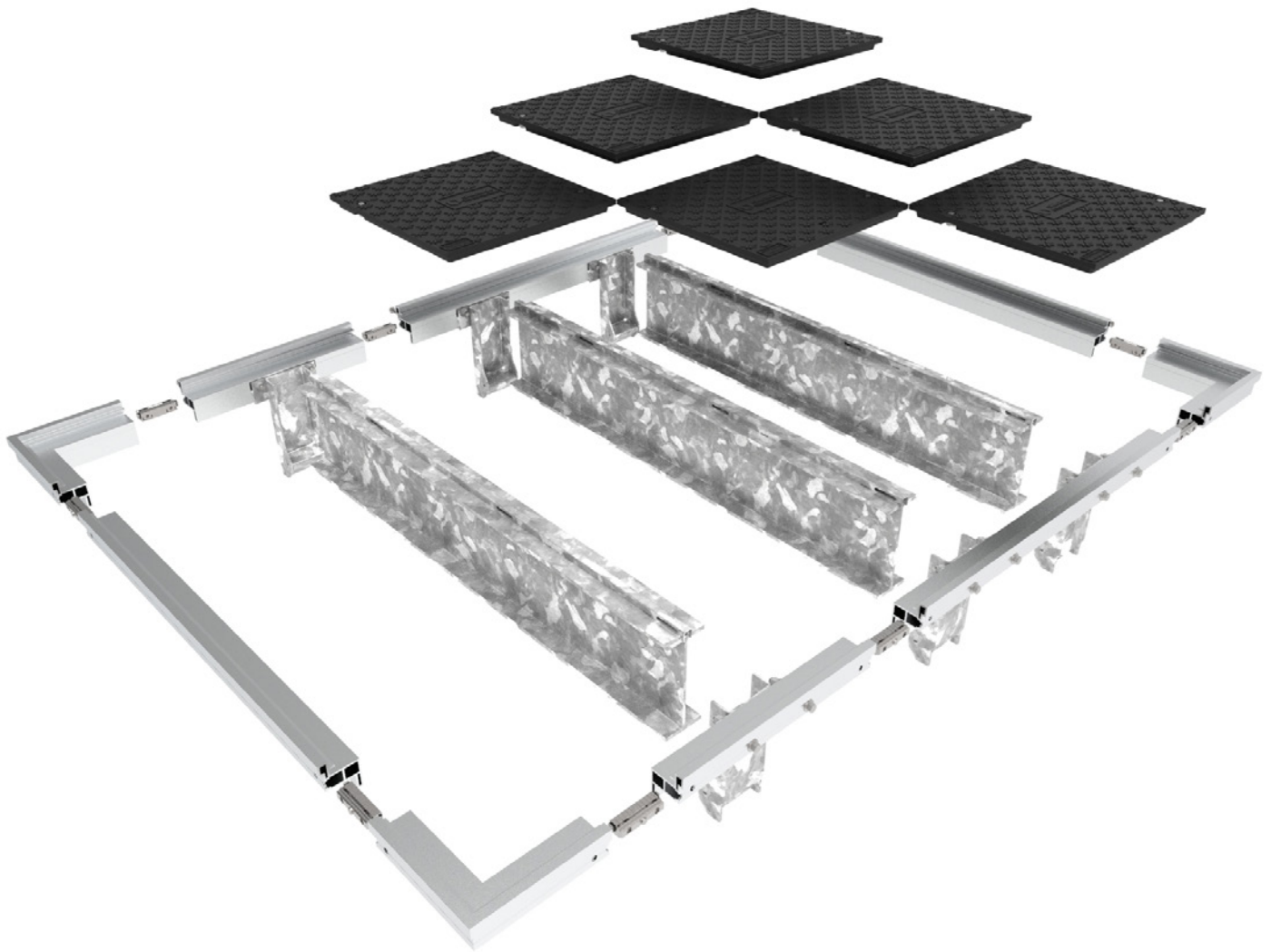

MODUcover

Frame and Cover System

Assembly Guide

Overview

MODUcover consists of standardized components that fit together to create the frame and cover system. The components are easily assembled and can be scaled both up and down depending on the vault requirements, making it the ideal solution for maximum adaptability on site.

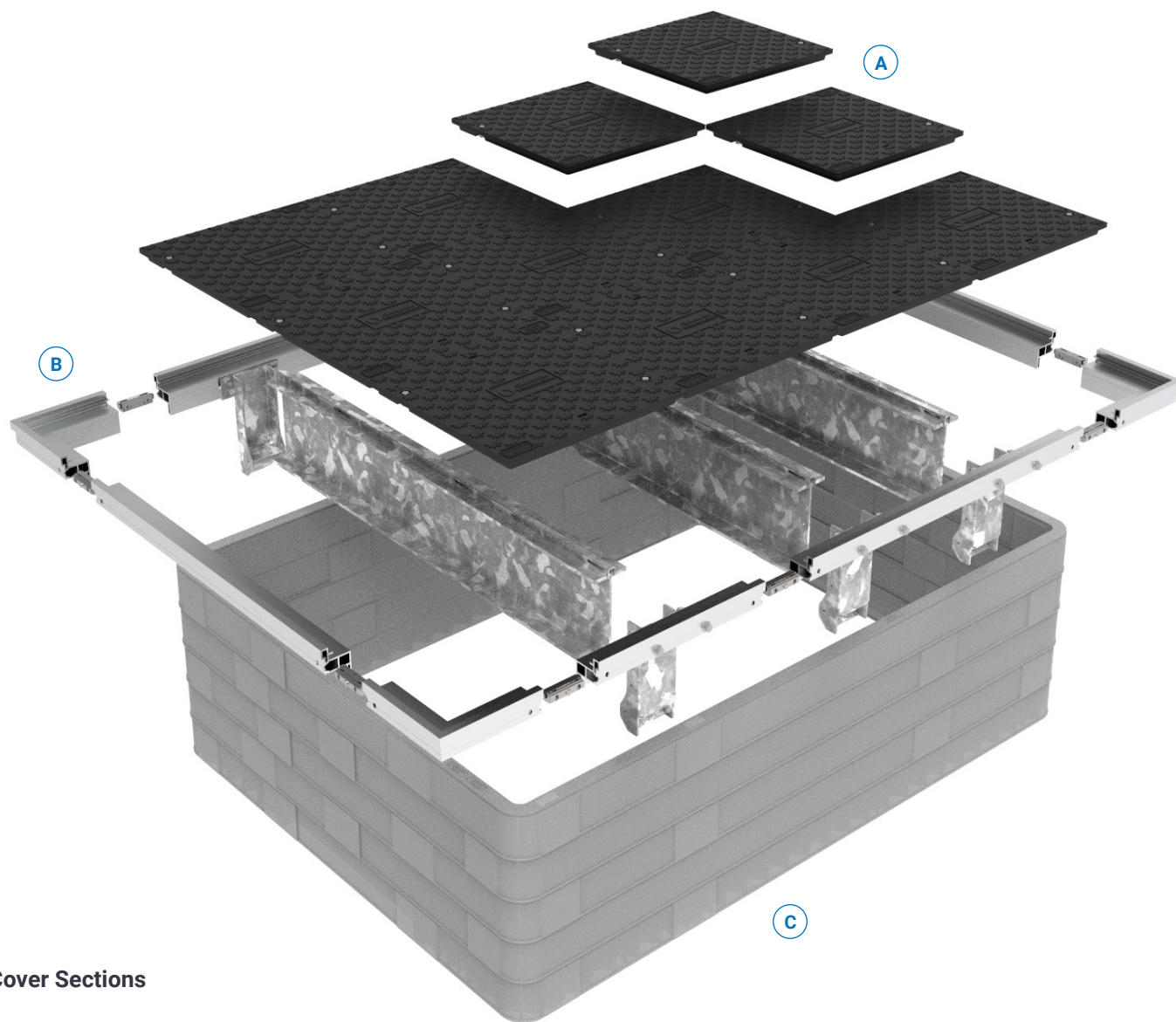

A. Cover Sections

B. Frame Components

C. STAKKAbOX™ ULTIMA Connect

Components

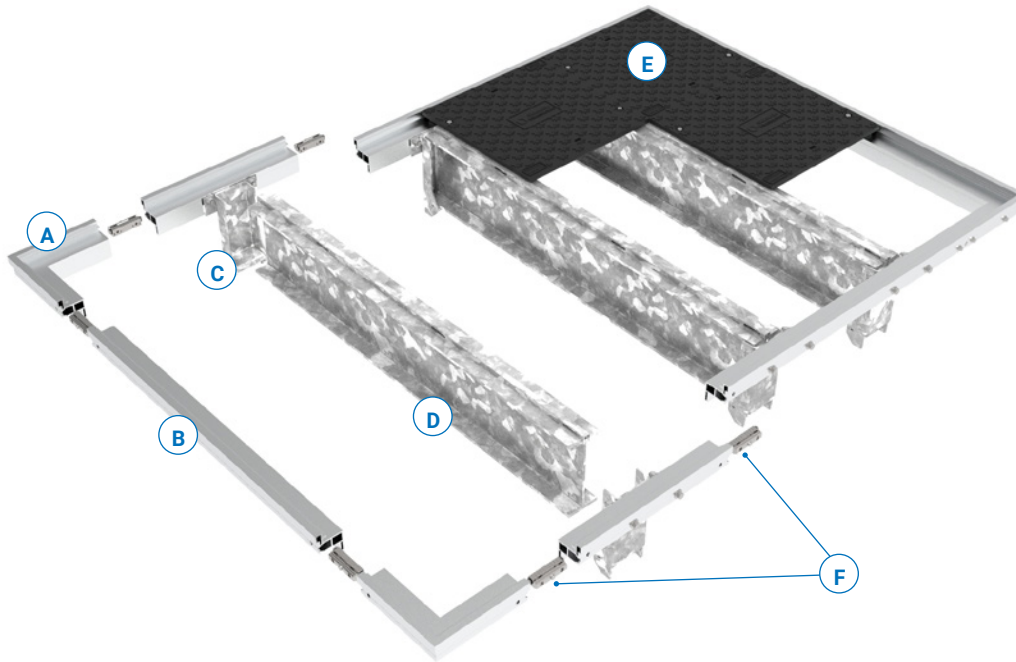

A. Corner

The MODUcover corner pieces offer a standardized profile that seamlessly integrate with varying straight lengths to reach the specified cover size required.

B. Straight Lengths

Standardized aluminum lengths enable scalability and ease of construction.

C. Beam Pocket

Aluminum pockets connect along straight lengths and spaced accordingly for the cover size.

D. Beam

Standardized aluminum lengths enable scalability and ease of construction.

E. Composite Covers

Composite covers provide a lightweight design with anti-slip tread pattern, lifting points, and locking features to maximize safety and optimize ease of access.

F. Connector

A uniquely developed connector, designed to enable ease of assembly.

Assembly



Step 1

Connect the corner pieces to the straight lengths using the connectors, making a c-shaped section.



Step 2

Assemble the required straight components to achieve the frame size required.



Beam Pocket Detail

Position beam pockets at the proper intervals for the vault and frame/cover size.

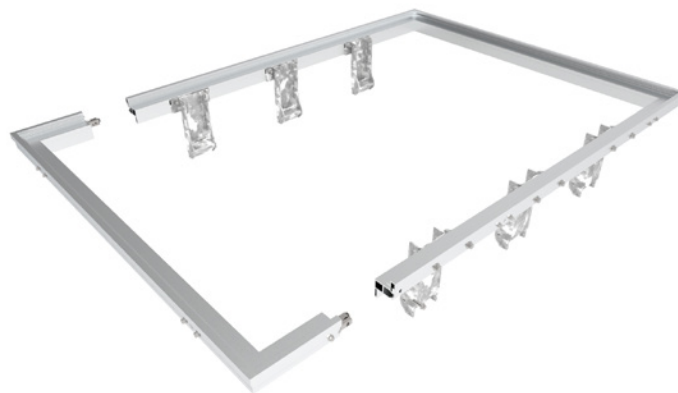

Step 3

Connect the remaining U-section of corners and straights to complete the full frame system.

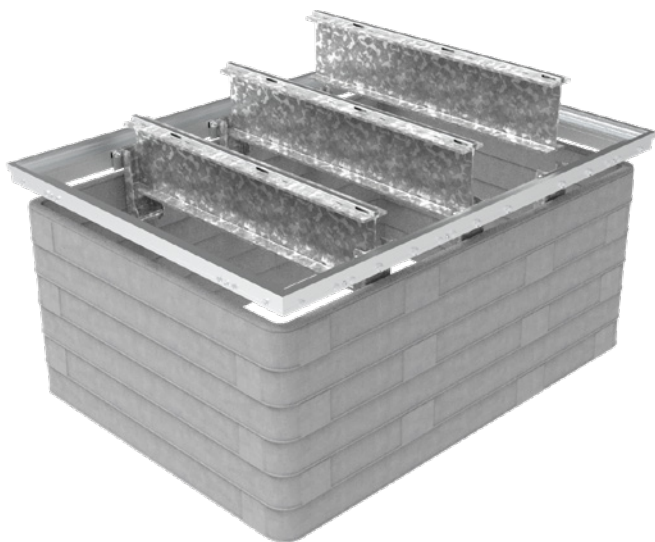

Step 4

Install the frame and beams into the vault as per required application specification.

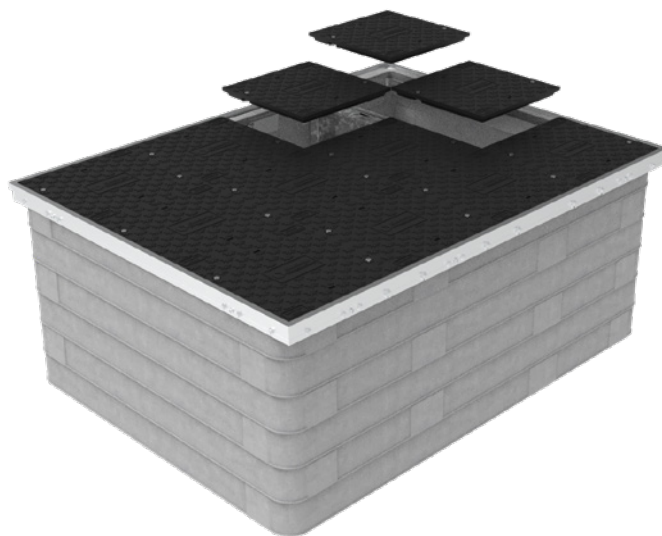

Step 5

Composite covers can be installed and locked, if applicable, providing easy access to the vault.

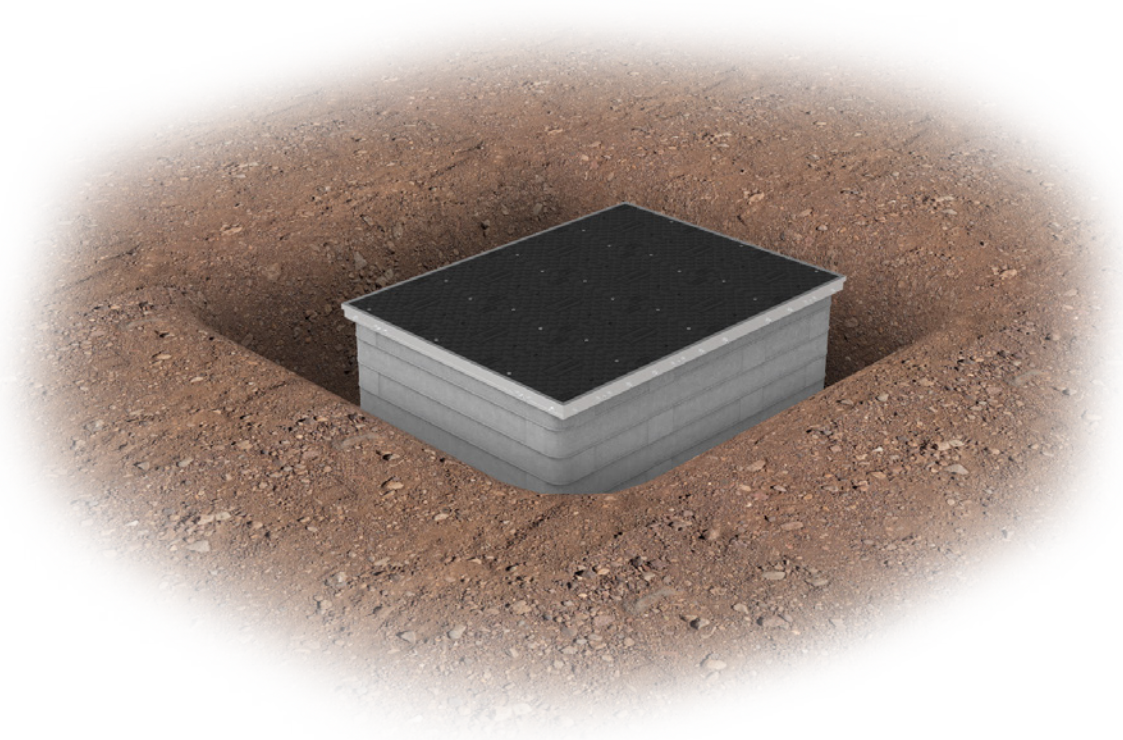

MODUcover

Frame and Cover System

Assembly Guide

Notes:

[illegible]

Frame and Cover System

Notes:

This image shows a single sheet of white paper with horizontal ruling lines. The lines are evenly spaced and run across the width of the page. There are no margins, text, or other markings on the paper.



www.oldcastleinfrastructure.com | (888) 965-3227

Trusted partnerships.
Full scale solutions.