

# Precast Concrete 96" Dia. Storm Catch Basin

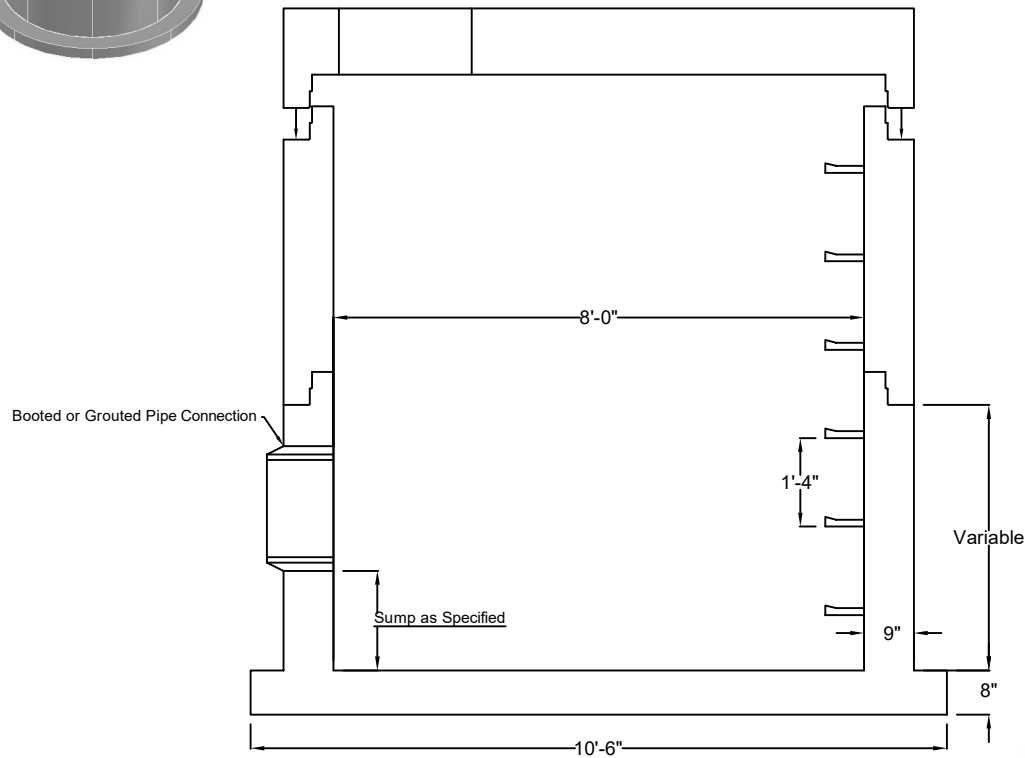
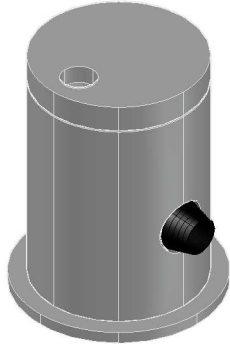

## Standard Features

- 4500 PSI Concrete @ 28 Days
- Conforms to ASTM C-478
- Design for H-20 Traffic Loading
- Manufactured in NPCA Certified Plant

## Standard Options

- Gasket Joint
- Cast Iron Frame and Cover
- 1", 2", 3" Precast Adjustment Rings
- Pipe Inlet/Outlet Holes Where Specified
- Booted Pipe Connections



7800 Adobe Rd.  
Kalamazoo, MI 49009  
269-342-0539

[www.qualityprecastinc.com](http://www.qualityprecastinc.com)